

## STRUCTURES ALUMINIUM

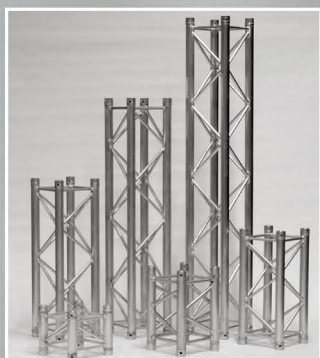

Europodium SAS design et produit ses propres structures aluminium compatibles avec celles des plus grandes marques présentes sur le marché. Nous utilisons le meilleur alliage d'aluminium : 6082 T6 afin d'assurer la meilleure qualité de poutre et de satisfaire pleinement les besoins de nos clients.

Notre force réside dans notre savoir-faire et dans notre capacité à fabriquer des poutres aluminium SUR-MESURE qui nous permettent de réagir de manière rapide et flexible à vos requêtes et de réaliser toutes les constructions sorties de votre imagination. Vous pouvez également faire appel à nous lors de votre phase de développement et compter sur notre expérience et notre expertise afin de vous accompagner et vous conseiller, du design à la production de votre projet.

*Europodium SAS designs and manufactures its own aluminum trusses compatible with the biggest brands present on the market. We are using the best aluminum quality: 6082 T6 in order to ensure the best possible quality and to satisfy our customers. Because we manufacture in-house, we are not only able to react flexibly and quickly, but can also supply customer-specific or project-specific designs.*

*Our "specials" - aluminum structures of every conceivable shape and size- are expertly produced to your exact specifications. You can also call on Europodium SAS's expertise and experience at the initial design stage.*

# ALUMINIUM TRUSS



STRUCTURES  
ALUMINIUM  
ALUMINIUM TRUSS

page

<b>CERCES</b> .....	62
<b>POUTRES</b> Série <b>G20</b> .....	64
<b>POUTRES</b> Série <b>G30/31</b> .....	68
<b>POUTRES</b> Série <b>G40/41</b> .....	76
<b>POUTRES</b> Série <b>G36</b> .....	84
<b>POUTRES</b> Série <b>G50</b> .....	88
<b>POUTRES</b> Série <b>G60R</b> .....	90
<b>POUTRES</b> Série <b>G100</b> .....	92
<b>POUTRES</b> Série <b>GAT 500</b> .....	94
<b>TRIPOD</b> .....	96
<b>ACCESSOIRES</b> .....	97

# CERCES

La fabrication de cerces est l'une des spécialités d'Europodium : tubes simples, cerces de section triangulaire, carrée, rectangulaire et elliptique. Quels que soit la forme, la dimension ou le type souhaités.

Nous produisons des poutres échelle, triangulaire, carrée, circulaire et elliptique ainsi que tous types de designs particuliers.

Toutes nos poutres sont disponibles dans une multitude de tailles : 20/20, 30/30, 30/40, 40/40 ou 40/60 et différentes épaisseurs de tube : 32 x 1,5, 50 x 2, 48 x 3, 50 x 3 ou 50 x 4 mm.

Une cerce complète est toujours livrée en pièces détachées. Nous conseillons toujours à nos clients un multiple de quatre afin d'accroître les possibilités d'utilisation. En outre, nous recommandons de ne pas créer de pièces cintrées supérieures à 3,5 mètres de long.

Le nombre de pièces peut être augmenté ou réduit, à la demande du client et selon les possibilités techniques.

L'achat d'une cerce en une seule pièce est également envisageable.

*The manufacturing of circles is one of the specialties of Europodium SAS. Single tubes, flat, triangle, square, rectangular and elliptical circles. Whatever the required shape, dimension or type, we can supply them. We manufacture trusses: ladder trusses, triangular, square, circular and elliptical trusses and all kinds of special truss designs.*

*All our trusses are available in a range of sizes: 20/20, 30/30, 30/40, 40/40 or 40/60 and tube thicknesses: 32 x 1.5, 50 x 2, 48 x 3, 50 x 3 or 50 x 4 mm.*

*A complete circle is always delivered in parts. You will find a list of standard possibilities with regard to dimensions and the number of parts in this brochure. For the number of parts we always advice our customers a multiple of four, so the possibilities in use of the circle are increased. We advise our customers to not make the bent parts longer than 3.5 meters.*

*The number of parts can be increased or decreased on request of the customer as far as this is technically possible. It is also possible to buy a part of a circle.*



Type ..... Tube

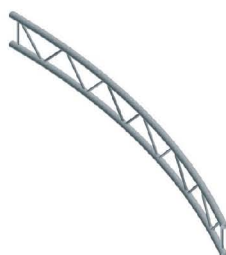

Type ..... Échelle verticale



Type ..... Échelle horizontale



Type ..... Pointe haute / basse

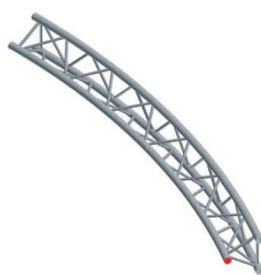

Type ..... Pointe intérieure

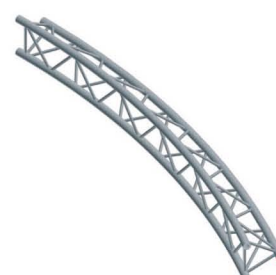

Type ..... Pointe extérieure

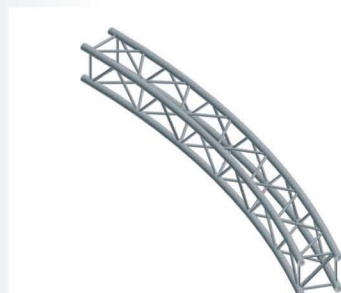

Type ..... Carrée

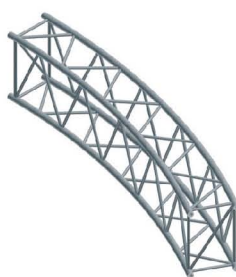

Type ..... Rectangulaire

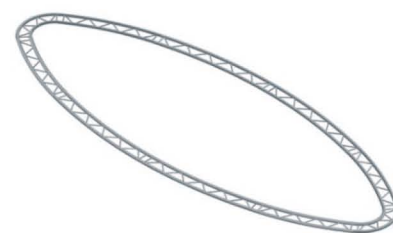

Type ..... En ellipse

# CERCES

∅ cm	*	TU502	TU483	G20E	G20T	G20C	G30E	G30T	G31T	G30C	G31C	G40E	G40T	G41T	G40C	G41C	G36R	G36C	G60
100	1	■	■																
150	1	■	■																
200	4	■	■	■	■	■	■	■	■	■	■	■	■	■	■	■			
250	4	■	■	■	■	■	■	■	■	■	■	■	■	■	■	■			
300	4	■	■	■	■	■	■	■	■	■	■	■	■	■	■	■			
350	4	■	■	■	■	■	■	■	■	■	■	■	■	■	■	■			
400	4	■	■	■	■	■	■	■	■	■	■	■	■	■	■	■			
450	4	■	■	■	■	■	■	■	■	■	■	■	■	■	■	■	■	■	■
500	8	■	■	■	■	■	■	■	■	■	■	■	■	■	■	■	■	■	■
550	8	■	■	■	■	■	■	■	■	■	■	■	■	■	■	■	■	■	■
600	8	■	■	■	■	■	■	■	■	■	■	■	■	■	■	■	■	■	■
650	8	■	■	■	■	■	■	■	■	■	■	■	■	■	■	■	■	■	■
700	8	■	■	■	■	■	■	■	■	■	■	■	■	■	■	■	■	■	■
750	8	■	■	■	■	■	■	■	■	■	■	■	■	■	■	■	■	■	■
800	8	■	■	■	■	■	■	■	■	■	■	■	■	■	■	■	■	■	■
850	8	■	■	■	■	■	■	■	■	■	■	■	■	■	■	■	■	■	■
900	8	■	■	■	■	■	■	■	■	■	■	■	■	■	■	■	■	■	■
950	8	■	■	■	■	■	■	■	■	■	■	■	■	■	■	■	■	■	■
1000	8	■	■	■	■	■	■	■	■	■	■	■	■	■	■	■	■	■	■
1100	12	■	■	■	■	■	■	■	■	■	■	■	■	■	■	■	■	■	■
1200	12	■	■	■	■	■	■	■	■	■	■	■	■	■	■	■	■	■	■
1250	12	■	■	■	■	■	■	■	■	■	■	■	■	■	■	■	■	■	■
1300	12	■	■	■	■	■	■	■	■	■	■	■	■	■	■	■	■	■	■
1400	12	■	■	■	■	■	■	■	■	■	■	■	■	■	■	■	■	■	■
1500	16	■	■	■	■	■	■	■	■	■	■	■	■	■	■	■	■	■	■
1600	16	■	■	■	■	■	■	■	■	■	■	■	■	■	■	■	■	■	■
1700	16	■	■	■	■	■	■	■	■	■	■	■	■	■	■	■	■	■	■
1800	16	■	■	■	■	■	■	■	■	■	■	■	■	■	■	■	■	■	■
1900	16	■	■	■	■	■	■	■	■	■	■	■	■	■	■	■	■	■	■
2000	16	■	■	■	■	■	■	■	■	■	■	■	■	■	■	■	■	■	■
2100	20	■	■	■	■	■	■	■	■	■	■	■	■	■	■	■	■	■	■
2200	20	■	■	■	■	■	■	■	■	■	■	■	■	■	■	■	■	■	■
2300	20	■	■	■	■	■	■	■	■	■	■	■	■	■	■	■	■	■	■
2400	20	■	■	■	■	■	■	■	■	■	■	■	■	■	■	■	■	■	■
2500	24	■	■	■	■	■	■	■	■	■	■	■	■	■	■	■	■	■	■
2600	24	■	■	■	■	■	■	■	■	■	■	■	■	■	■	■	■	■	■
2700	24	■	■	■	■	■	■	■	■	■	■	■	■	■	■	■	■	■	■
2800	24	■	■	■	■	■	■	■	■	■	■	■	■	■	■	■	■	■	■
2900	24	■	■	■	■	■	■	■	■	■	■	■	■	■	■	■	■	■	■
3000	24	■	■	■	■	■	■	■	■	■	■	■	■	■	■	■	■	■	■

\* Nombre de pièces recommandées • Différentes tailles sur demande  
 \* Number of rooms recommended • Different sizes on request

# POUTRES SÉRIE G20

La série G20 convient particulièrement bien à l'intégration d'une touche décorative dans divers intérieurs. Elle est idéale pour une utilisation dans les magasins et/ou les salles d'exposition, pour les dispositifs d'affichage et les banderoles, particulièrement en tant qu'élément décoratif du fait de ses petites dimensions et de son léger poids associés à une grande capacité de charge. Quel que soit le milieu, la série G20 retient l'attention grâce à son design industriel remarquable. Elle est disponible en aluminium brillant ou en toute autre couleur RAL grâce à l'utilisation de couleurs et finitions avec revêtement époxy.

*The G20 series is particularly suitable for the integration of a decorative touch in various interiors. G20 series is ideal for use in shops and / or showrooms for display devices and banners, especially as a decorative because of its small size and its light weight associated with a high load capacity.*

*Whatever the medium, the G20 series holds the attention with its outstanding industrial design. It is available in polished aluminum or any other RAL color through the use of colors and finishes with epoxy coating*

## Spécifications techniques

Type	E = échelle T = triangle C = carré
Alliage	51 st AlMgSi 1 F31 ISO standard AlMgSi EN-AW 6082 T6
Tube	20 ø 32 x 1,5 mm
Croisillon	20 ø 10 x 1 mm
Connexion	Manchons, goupilles et broches G20

Les raccords coniques (taille mini) permettent un assemblage rapide et aisé sans l'aide d'outils. Europodium commercialise un large assortiment de poutres, d'arcs et de montages spéciaux basés sur la série G20.

*Adapters (mini size) allow for quick and easy assembly without tools. Europodium sells a wide range of beams, arches and special assemblies based on the G20 series.*

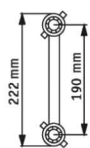

G20E

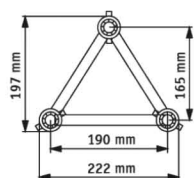

G20T

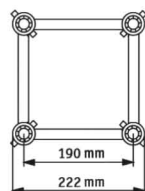

G20C

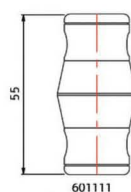

G20/MC

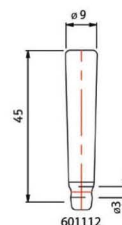

G20/GC

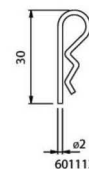

G20/BS



G20/GCM6



G20E

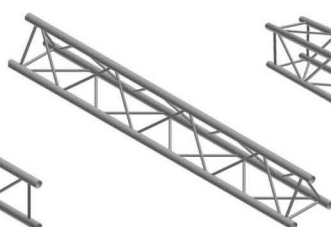

G20T

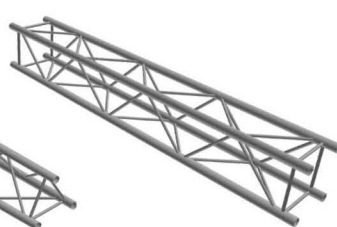

G20C



Pièces de connexion

## Série G20 - tube ø 32 x 1,5 mm

Standard (m)	0,25	0,50	0,75	1,00	1,50	2,00	2,50	3,00
G20E (kg)	0,60	0,80	1,00	1,10	1,50	2,00	2,40	2,90
G20T (kg)	1,20	1,40	1,60	1,80	2,60	3,40	4,00	4,90
G20C (kg)	1,80	2,00	2,30	2,50	3,50	4,50	5,50	6,50

**POUTRES** Série **G20E**

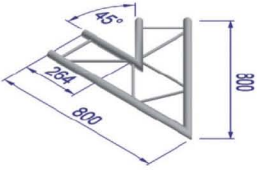

Type  
A2D45 ..... Angle 2 directions 45°

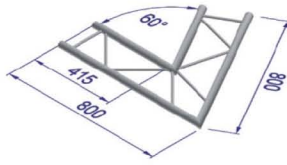

Type  
A2D60 ..... Angle 2 directions 60°

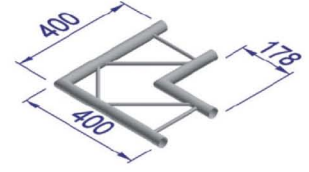

Type  
A2D90 ..... Angle 2 directions 90°

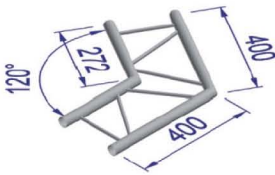

Type  
A2D120 ..... Angle 2 directions 120°

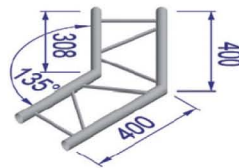

Type  
A2D135 ..... Angle 2 directions 135°

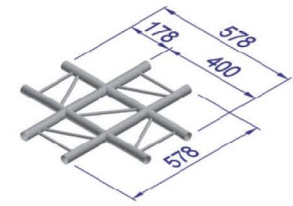

Type  
A4D ..... Angle 4 directions

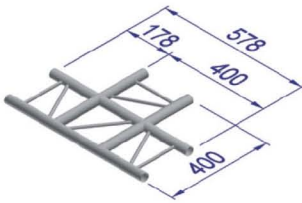

Type  
A3D ..... Angle 3 directions

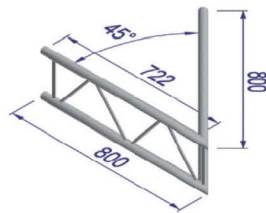

Type  
A2D45 ..... Angle 2 directions 45°

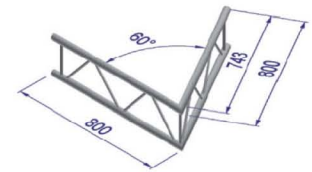

Type  
A2D60 ..... Angle 2 directions 60°



Type  
A2D90 ..... Angle 2 directions 90°



Type  
A2D120 ..... Angle 2 directions 120°

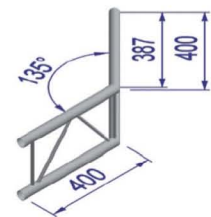

Type  
A2D135 ..... Angle 2 directions 135°

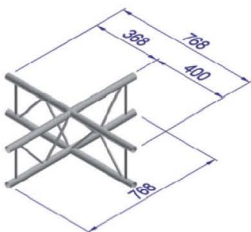

Type  
A4D ..... Angle 4 directions

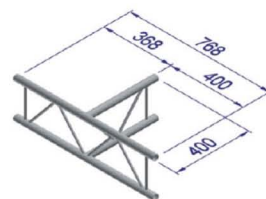

Type  
A3D ..... Angle 3 directions

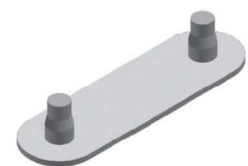

Type  
EMBP ..... Embase plate

## POUTRES Série G20T

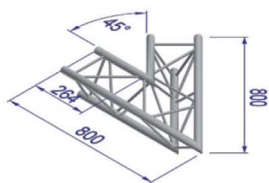

Type  
A2D45 ..... Angle 2 directions 45°

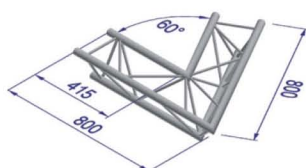

Type  
A2D60 ..... Angle 2 directions 60°

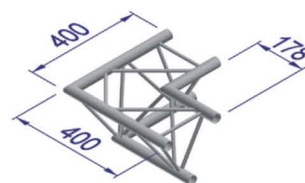

Type  
A2D90 ..... Angle 2 directions 90°



Type  
A2D120 ..... Angle 2 directions 120°

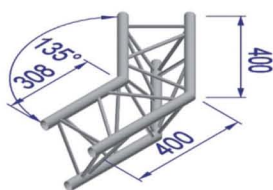

Type  
A2D135 ..... Angle 2 directions 135°

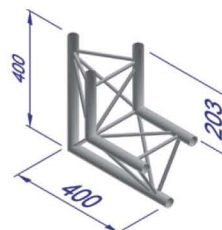

Type  
A1DPH .... Angle portique pointe haute

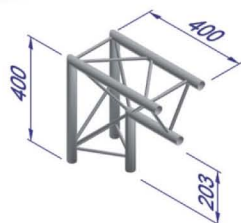

Type  
A1DPB .... Angle portique pointe basse

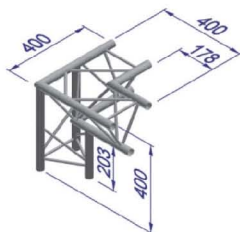

Type  
A2D90P ..... Angle 2 directions 90°  
+ pied gauche

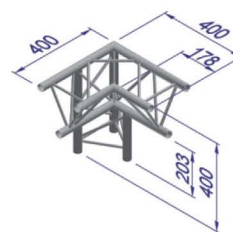

Type  
A2D90P ..... Angle 2 directions 90°  
+ pied droit

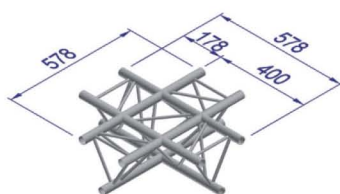

Type  
A4D ..... Angle 4 directions

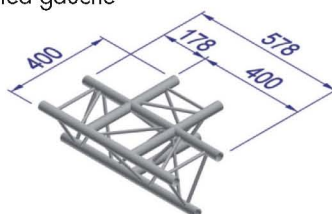

Type  
A3D ..... Angle 3 directions



Type  
A2D180P .. Angle 2 directions 180° + pied

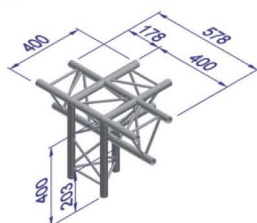

Type  
A3DP ..... Angle 3 directions + pied

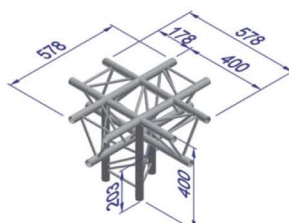

Type  
A4DP ..... Angle 4 directions + pied

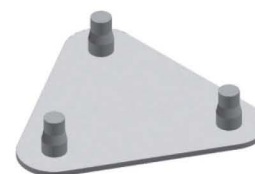

Type  
EMBP ..... Embase plate

### Charges admissibles • POUTRE G20T - membrure principale ø 32 x 1,5 mm

Longueur (M) / Span	2	3	4	5	6	7	8	9	10
Charge ponctuelle (kg) / CPL	183	181	179	146	120	102	88	75	67
Charge 3 points (Kg à 1/4 ; 1/2 ; 3/4) / 3PL	62	61	60	60	60	51	45	38	33
Charge uniformément répartie (kg/M) / UDL/M	92	61	45	36	30	25	22	17	14
Charge uniformément répartie (kg) / UDL	184	183	180	180	180	175	176	153	140

## POUTRES Série G20C

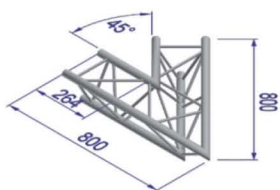

Type A2D45 ..... Angle 2 directions 45°

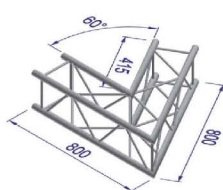

Type A2D60 ..... Angle 2 directions 60°

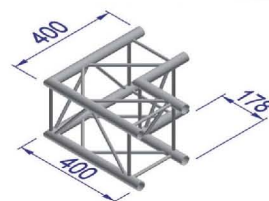

Type A2D90 ..... Angle 2 directions 90°

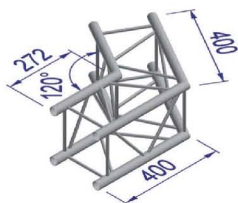

Type A2D120 ..... Angle 2 directions 120°

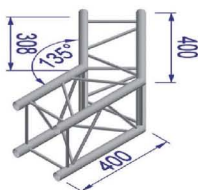

Type A2D135 ..... Angle 2 directions 135°

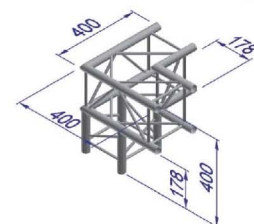

Type A2D90P .. Angle 2 directions 90°+ pied

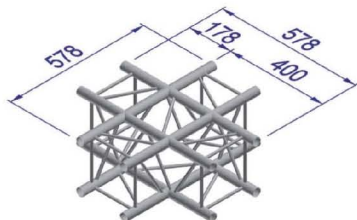

Type A4D ..... Angle 4 directions

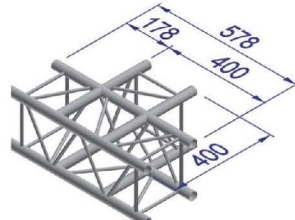

Type A3D ..... Angle 3 directions

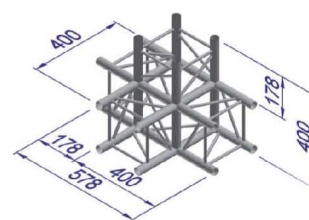

Type A3DP ..... Angle 3 directions + pied

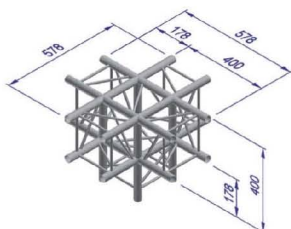

Type A4DP ..... Angle 4 directions + pied

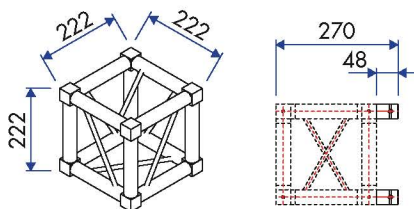

Type Box Corner

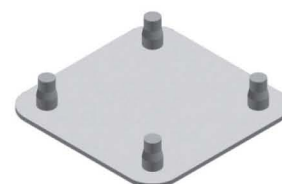

Type EMBP ..... Embase plate

### Charges admissibles • POUTRE G20C - membrure principale ø 32 x 1,5 mm

Longueur (M) / Span	2	3	4	5	6	7	8	9	10
Charge ponctuelle (kg) / CPL	531	526	392	311	256	217	187	164	144
Charge 3 points (Kg à 1/4 ; 1/2 ; 3/4) / 3PL	177	176	175	155	128	109	94	82	73
Charge uniformément répartie (kg/M) / UDL/M	266	176	132	105	85	63	46	36	29
Charge uniformément répartie (kg) / UDL	532	528	528	525	510	441	368	324	290

STRUCTURES ALUMINIUM ALUMINIUM TRUSS

# POUTRES SÉRIE G30 / G31

La série G30 / G31 a été spécialement conçue pour les éclairages et les systèmes sonores professionnels dans les parcs expositions, les discothèques, concerts et salles de spectacles. Le raccord conique vous permet d'assembler le système très rapidement. Europodium commercialise une large gamme de poutres, d'arcs de cercles et de montages spéciaux basés sur la série G30. Les séries G30 / G31 appartiennent à la catégorie de poutres de résistance moyenne, dont les dimensions sont les plus répandues dans notre secteur d'activité.

*Series G30 / G31 has been specially designed for lighting and sound systems for professional exhibitions and nightclubs. The flare lets you assemble the system very quickly. Europodium markets: a wide range of beams, arches, circles and special assemblies based on the G30 series. Series G30 / G31 belong to the category of medium strength truss whose dimensions are the most common in our industry.*

## Spécifications techniques

Type	E = échelle T = triangle C = carré	
Alliage	51 st AlMgSi 1 F31 ISO standard AlMgSi EN-AW 6082 T6	
Tube	30 ø 50 x 2 mm - 31 ø 48 x 3 mm	
Croisillon	30 ø 16 x 2 mm - 31 ø 16 x 2 mm	
Connexion	Manchons, goupilles et broches	

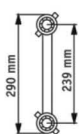

G30E / G31E

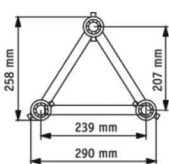

G30T / G31T

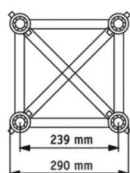

G30C / G31C

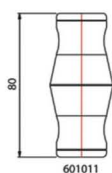

MC

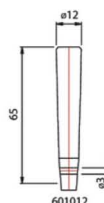

GC

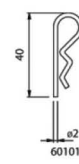

BS

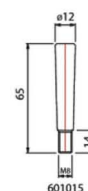

GCM8



G30E / G31E



G30T / G31T

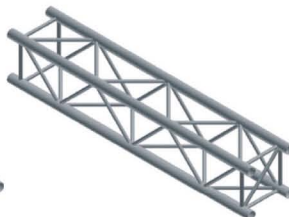

G30C / G31C



Pièces de connexion

## Série G30 - tube ø 50 x 2 mm

Standard (m)	0,29	0,50	0,71	1,00	1,50	2,00	2,50	3,00	3,50	4,00	4,50	5,00
G30E (kg)	0,61	1,05	1,49	2,10	3,15	4,19	5,24	6,29	7,34	8,39	9,44	10,49
G30T (kg)	1,12	1,94	2,75	3,87	5,81	7,75	9,68	11,62	13,56	15,49	17,43	19,37
G30C (kg)	1,51	2,60	3,69	5,20	7,80	10,40	13,00	15,60	18,20	20,80	23,39	25,99

## Série G31 - tube ø 48 x 3 mm

Standard (m)	0,29	0,50	0,71	1,00	1,50	2,00	2,50	3,00	3,50	4,00	4,50	5,00
G31E (kg)	0,61	1,05	1,49	2,77	4,16	5,54	6,93	8,31	9,70	11,08	12,47	13,86
G31T (kg)	1,39	2,40	3,40	4,79	7,19	9,58	11,98	14,37	16,77	19,16	21,56	23,96
G31C (kg)	1,86	3,21	4,56	6,42	9,63	12,84	16,06	19,27	22,48	25,69	28,90	32,11

**POUTRES** Série **G30E / G31E**

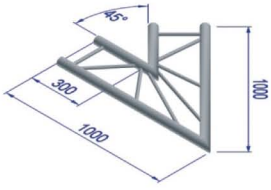

Type  
A2D45 ..... Angle 2 directions 45°

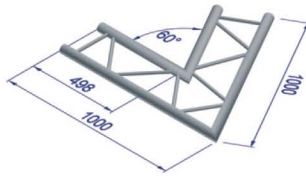

Type  
A2D60 ..... Angle 2 directions 60°

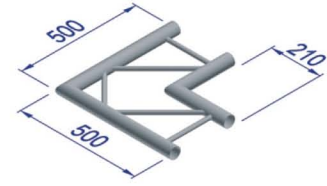

Type  
A2D90 ..... Angle 2 directions 90°

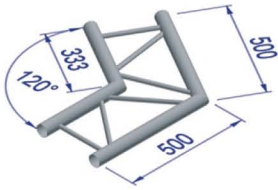

Type  
A2D120 ..... Angle 2 directions 120°

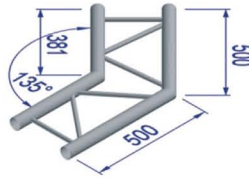

Type  
A2D135 ..... Angle 2 directions 135°

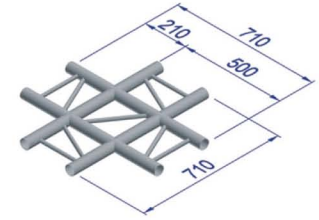

Type  
A4D ..... Angle 4 directions

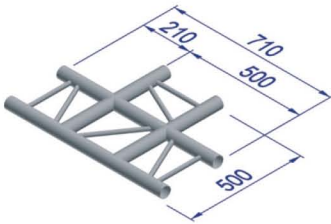

Type  
A3D ..... Angle 3 directions

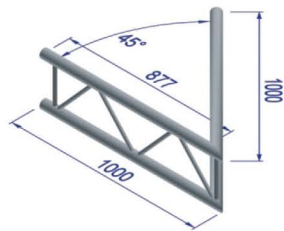

Type  
A2D45 ..... Angle 2 directions 45°

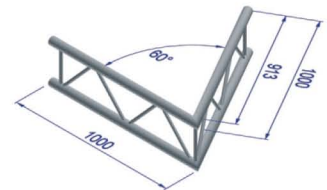

Type  
A2D60 ..... Angle 2 directions 60°

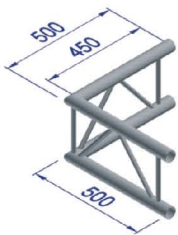

Type  
A2D90 ..... Angle 2 directions 90°

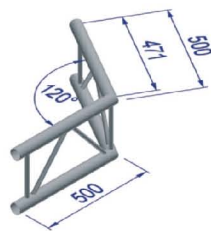

Type  
A2D120 ..... Angle 2 directions 120°

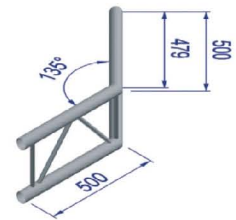

Type  
A2D135 ..... Angle 2 directions 135°

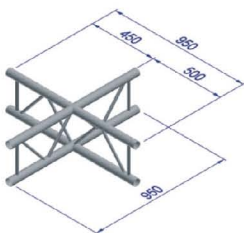

Type  
A4D ..... Angle 4 directions

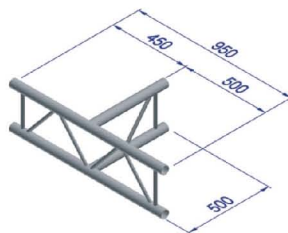

Type  
A3D ..... Angle 3 directions

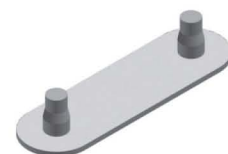

Type  
EMBP ..... Embase plate

STRUCTURES  
ALUMINIUM  
ALUMINIUM TRUSS

## POUTRES Série G30T / G31T

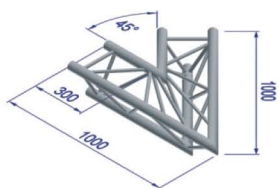

Type  
A2D45 ..... Angle 2 directions 45°

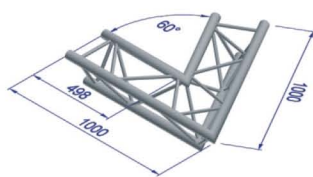

Type  
A2D60 ..... Angle 2 directions 60°



Type  
A2D90 ..... Angle 2 directions 90°

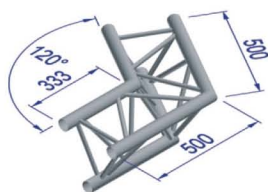

Type  
A2D120 ..... Angle 2 directions 120°

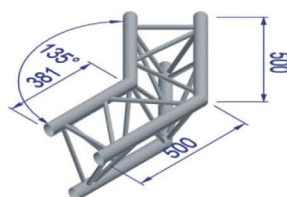

Type  
A2D135 ..... Angle 2 directions 135°

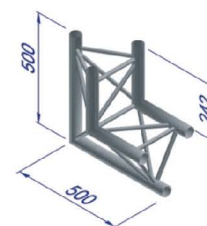

Type  
A1DPH ..... Angle portique pointe haute

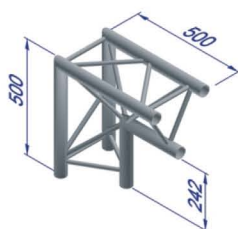

Type  
A1DPB ..... Angle portique pointe basse

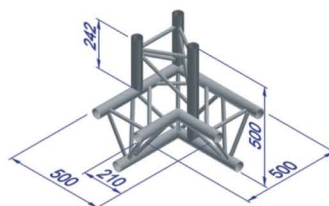

Type  
A2D90PH ..... Angle 2 directions 90°  
+ pied gauche

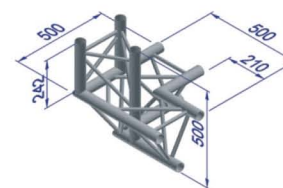

Type  
A2D90PH ..... Angle 2 directions 90°  
+ pied droit

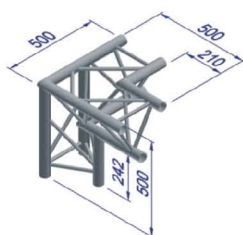

Type  
A2D90PB ..... Angle 2 directions 90°  
+ pied gauche



Type  
A2D90PB Angle 2 directions 90° + pied



Type  
A2DP ..... Angle de « bar »

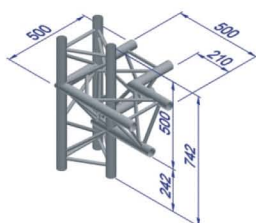

Type  
A2DP ..... Angle de "bar"

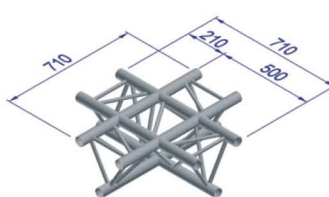

Type  
A4D ..... Angle 4 directions



Type  
CHA ..... Angle charnière

**POUTRES** Série **G30T / G31T**

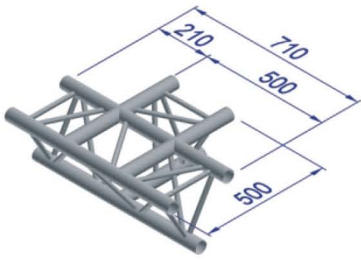

Type  
A3D ..... Angle 3 directions

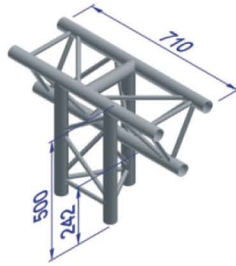

Type  
A2D180P .. Angle 2 directions 180° + pied

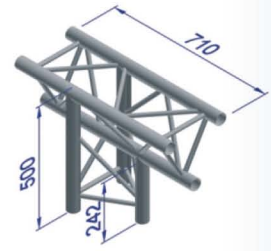

Type  
A2D180P .. Angle 2 directions 180° + pied

Pointe basse

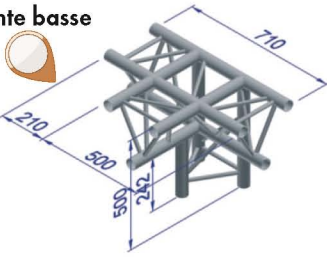

Type  
A3DP ..... Angle 3 directions + pied

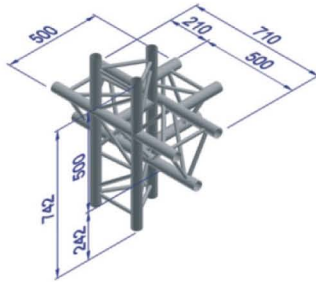

Type  
A3DPH Angle 3 directions + pied + haut

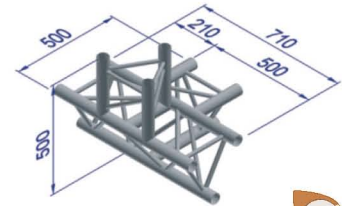

Type  
A3DP ..... Angle 3 directions + pied

Pointe haute

Pointe haute

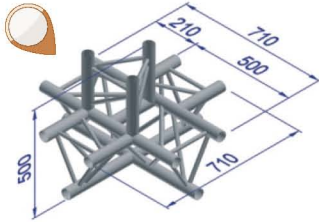

Type  
A4DP ..... Angle 4 directions + pied

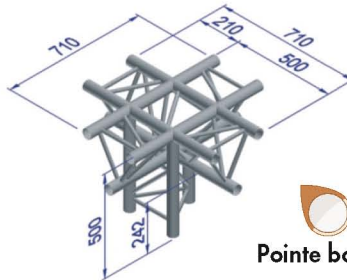

Type  
A4DP ..... Angle 4 directions + pied

Pointe basse

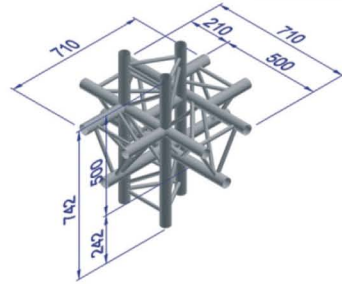

Type  
A4DPH Angle 4 directions + pied + haut

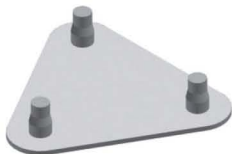

Type  
EMBP ..... Embase plate



## POUTRES Série G30C / G31C

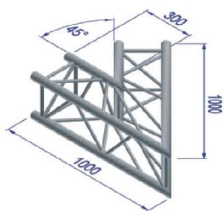

Type  
A2D45 ..... Angle 2 directions 45°

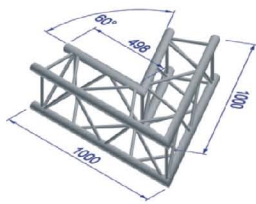

Type  
A2D60 ..... Angle 2 directions 60°

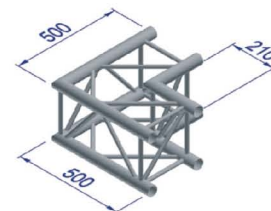

Type  
A2D90 ..... Angle 2 directions 90°

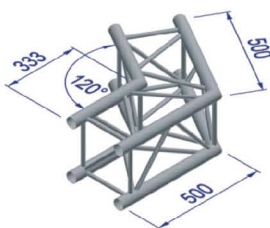

Type  
A2D120 ..... Angle 2 directions 120°

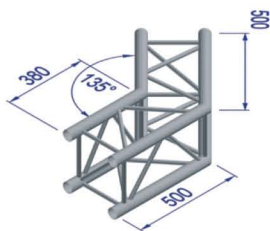

Type  
A2D135 ..... Angle 2 directions 135°

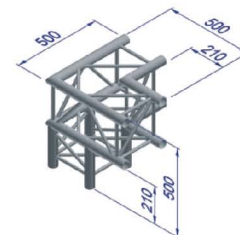

Type  
A2D90P .. Angle 2 directions 90° + pied

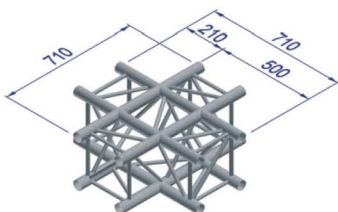

Type  
A4D ..... Angle 4 directions

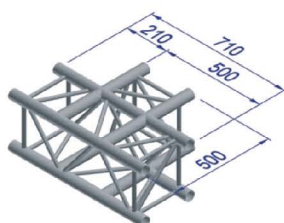

Type  
A3D ..... Angle 3 directions

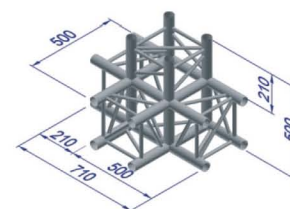

Type  
A3DP ..... Angle 3 directions + pied

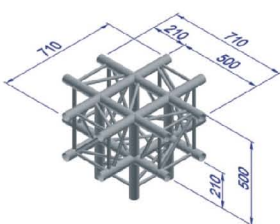

Type  
A4DP ..... Angle 4 directions + pied

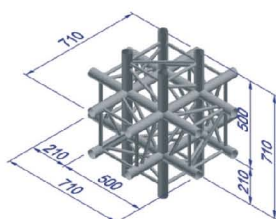

Type  
A4DPH ... Angle 4 directions + pied + haut

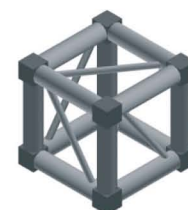

Type  
Boxcorner

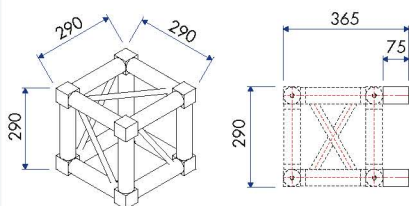

Type  
Boxcorner

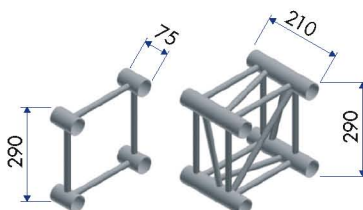

Type  
Raccord pour chariot de levage  
et boxcorner



Type  
EMBP ..... Embase plate

**POUTRES** Série **G30C / G31C**



STRUCTURES  
ALUMINIUM  
ALUMINIUM TRUSS

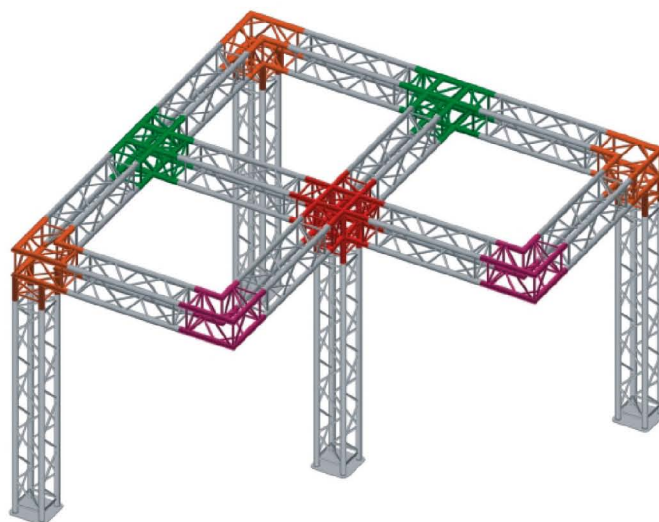
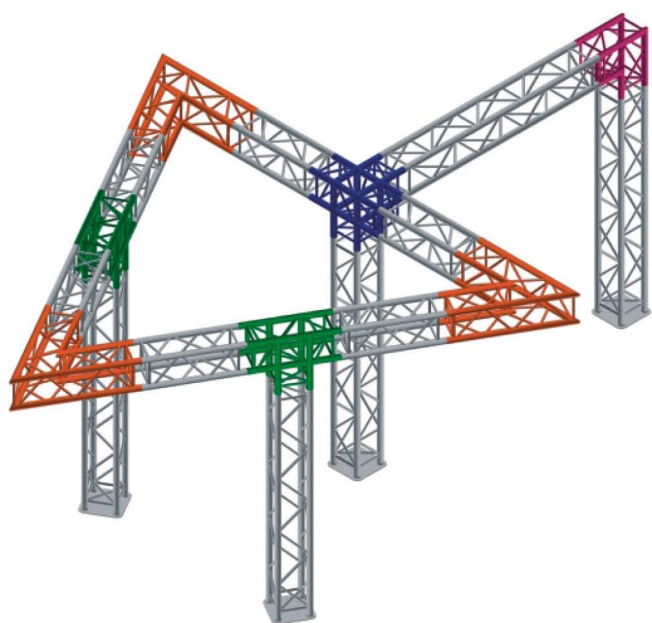

## POUTRES SÉRIE **G30** / **G31** Échelle • Charges admissibles

### Poutre **G30E** - membrure principale $\varnothing 50 \times 2$ mm - croisillon $\varnothing 16 \times 2$ mm

Longueur (M) / Span	1	2	3	4	5
Charge ponctuelle (kg) / CPL	295	236	115	57	28
Charge uniformément répartie (kg/M) / UDL/M	1419	482	102	31	11
Charge uniformément répartie (kg) / UDL	1419	964	306	124	55

### Poutre **G31E** - membrure principale $\varnothing 48 \times 3$ mm - croisillon $\varnothing 16 \times 2$ mm

Longueur (M) / Span	1	2	3	4	5
Charge ponctuelle (kg) / CPL	905	610	180	73	33
Charge 3 points (kg à 1/4, 1/2 et 3/4) / 3PL	315	242	91	36	16
Charge uniformément répartie (kg/M) / UDL/M	1012	362	118	36	13
Charge uniformément répartie (kg) / UDL	1012	723	354	142	65

## POUTRES SÉRIE **G30** / **G31** Triangulaire • Charges admissibles

### Poutre **G30T** - membrure principale $\varnothing 50 \times 2$ mm - croisillon $\varnothing 16 \times 2$ mm

Longueur (M) / Span	2	3	4	5	6	7
Charge ponctuelle (kg) / CPL	896	594	443	351	290	245
Charge 3 points (kg à 1/4, 1/2 et 3/4) / 3PL	448	297	222	176	145	123
Charge uniformément répartie (kg/M) / UDL/M	673	396	221	141	97	70
Charge uniformément répartie (kg) / UDL	1346	1188	884	705	582	490

### Poutre **G31T** - membrure principale $\varnothing 48 \times 3$ mm - croisillon $\varnothing 16 \times 2$ mm

Longueur (M) / Span	2	3	4	5	6	7
Charge ponctuelle (kg) / CPL	1284	852	635	504	415	351
Charge 3 points (kg à 1/4, 1/2 et 3/4) / 3PL	583	426	317	252	208	176
Charge uniformément répartie (kg/M) / UDL/M	874	568	317	201	138	100
Charge uniformément répartie (kg) / UDL	1748	1704	1270	1007	831	703

## POUTRES SÉRIE **G30** / **G31** Carrée • Charges admissibles

### Poutre **G30C** - membrure principale $\varnothing 50 \times 2$ mm - croisillon $\varnothing 16 \times 2$ mm

Longueur (M) / Span	2	3	4	5	6	7
Charge ponctuelle (kg) / CPL	1342	1338	1029	819	679	577
Charge 3 points (kg à 1/4, 1/2 et 3/4) / 3PL	448	446	444	410	339	289
Charge uniformément répartie (kg/M) / UDL/M	672	446	334	266	221	165
Charge uniformément répartie (kg) / UDL	1344	1338	1336	1330	1326	1155

### Poutre **G31C** - membrure principale $\varnothing 48 \times 3$ mm - croisillon $\varnothing 16 \times 2$ mm

Longueur (M) / Span	2	3	4	5	6	7
Charge ponctuelle (kg) / CPL	2018	1982	1481	1179	976	830
Charge 3 points (kg à 1/4, 1/2 et 3/4) / 3PL	673	670	668	589	488	415
Charge uniformément répartie (kg/M) / UDL/M	1009	670	501	400	325	237
Charge uniformément répartie (kg) / UDL	2018	2011	2005	1998	1952	1661

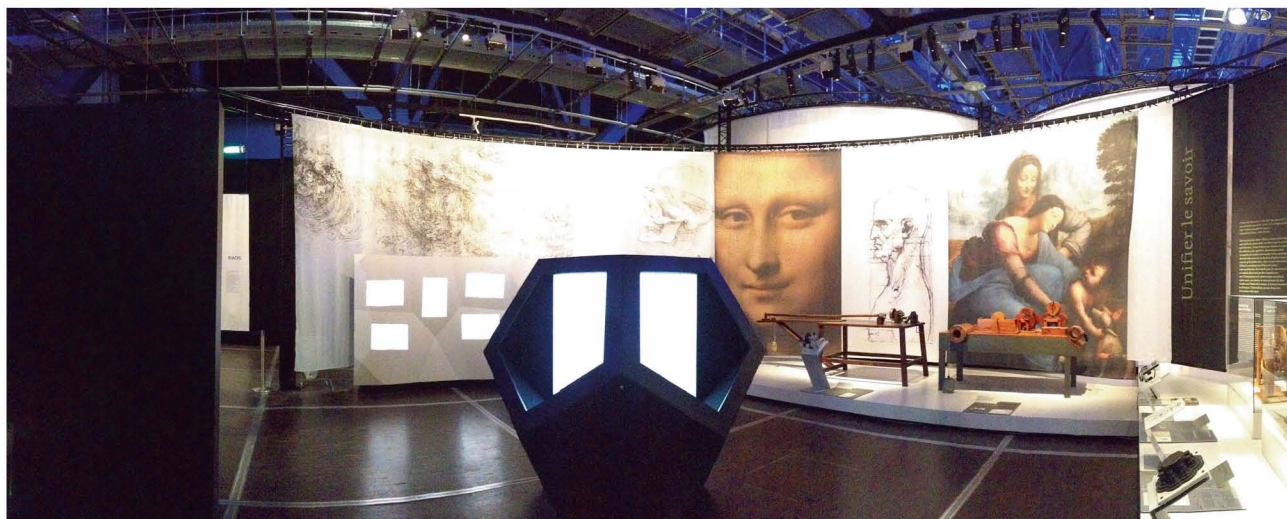

STRUCTURES  
ALUMINIUM  
ALUMINIUM TRUSS



8	9	10	12	14	16
212	185	163	130	105	86
106	93	82	65	53	43
53	41	33	22	15	11
424	369	330	264	210	176



8	9	10	11	12	13	14	15	16
303	265	234	208	186	167	151	136	123
152	132	117	104	93	84	75	68	61
76	59	47	38	31	26	22	18	15
606	530	468	416	372	334	301	272	246



8	9	10	12	14	16
501	441	393	319	266	224
251	221	197	160	133	112
125	98	77	53	38	28
1000	882	770	636	532	448



8	9	10	11	12	13	14	15	16
720	634	564	507	458	417	380	349	320
360	317	282	253	229	208	190	174	160
180	141	113	92	76	64	54	46	40
1441	1268	1129	1014	916	833	761	697	641

# POUTRES SÉRIE G40 / G41

La série G40/G41 représente la ligne la plus robuste et la plus large parmi les poutres triangles milieu de gamme. Tout comme pour la série G30/G31, les poutres ont été conçues spécifiquement pour les éclairages et les équipements sonores professionnels des expositions, lieux de divertissements, théâtres et discothèques. Grâce à sa plus grande taille, 390 x 390 mm, la capacité de charge et la portée maximale sont supérieures à celles de la série G30/G31, ce qui accroît les possibilités d'utilisations.

Ce petit plus est souvent requis dans les projets à grande échelle.

*The Series G40/G41 line is the most robust and wider among midrange trusses. As for the series G30/G31, the truss were designed specifically for lighting and sound equipment for professional exhibitions, entertainment venues, theaters and nightclubs. Thanks to its larger size, 390 x 390 mm, the carrying capacity is higher than the series G30/G31 which increases the using possibilities.*

*That little more is often required in large-scale projects.*

## Spécifications techniques

Type	E = échelle T = triangle C = carré
Alliage	51 st AlMgSi F31 ISO standard AlMgSi EN-AW 6082 T6
Tube	40 ø 50 x 2 mm - 41 ø 48 x 3 mm
Croissillon	40 ø 20 x 2 mm - 41 ø 20 x 2 mm
Connexion	Manchons, goupilles et broches



Europodium commercialise une large gamme de produits particuliers basés sur la série G40 et G41. Le raccord conique (identique à celui de la série G30/G31) vous permet d'assembler le système très rapidement.

*Europodium markets a wide range of specific products based on the series G40 and G41. The conical coupler (same as Series G30/G31) allows you to assemble the system very quickly.*

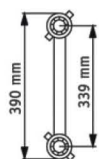

G40E / G41E

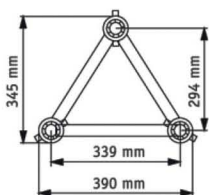

G40T / G41T

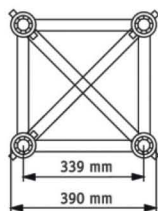

G40C / G41C

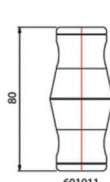

MC

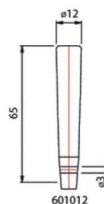

GC

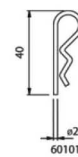

BS

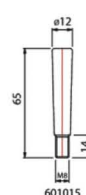

GCM8



G40E / G41E

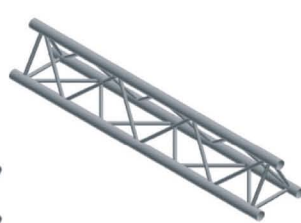

G40T / G41T

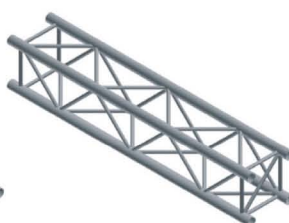

G40C / G41C



Pièces de connexion

## Série G40 - tube ø 50 x 2 mm

Standard (m)	0,29	0,50	1,00	1,50	2,00	2,50	3,00	3,50	4,00	4,50	5,00
G40E (kg)	0,59	1,02	2,03	3,05	4,06	5,08	6,09	7,11	8,12	9,14	10,16
G40T (kg)	1,15	1,99	3,98	5,97	7,96	9,95	11,94	13,93	15,92	17,91	19,90
G40C (kg)	1,65	2,84	5,68	8,52	11,36	14,21	17,05	19,89	22,73	25,57	28,41

## Série G41 - tube ø 48 x 3 mm

Standard (m)	0,29	0,50	1,00	1,50	2,00	2,50	3,00	3,50	4,00	4,50	5,00
G41E (kg)	0,78	1,35	2,71	4,06	5,41	6,76	8,12	9,47	10,82	12,17	13,53
G41T (kg)	1,45	2,50	4,99	7,49	9,99	12,49	14,98	17,48	19,98	22,48	24,97
G41C (kg)	2,04	3,52	7,03	10,55	14,07	17,58	21,10	24,62	28,13	31,65	35,17

**POUTRES** Série **G40E / G41E**

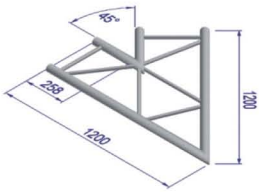

Type  
A2D45 ..... Angle 2 directions 45°

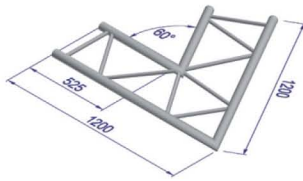

Type  
A2D60 ..... Angle 2 directions 60°

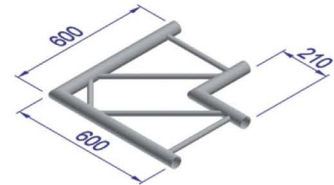

Type  
A2D90 ..... Angle 2 directions 90°

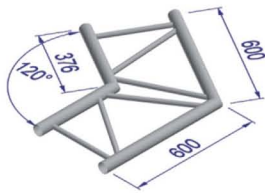

Type  
A2D120 ..... Angle 2 directions 120°

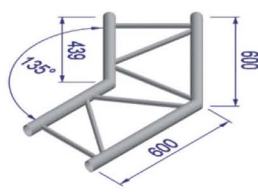

Type  
A2D135 ..... Angle 2 directions 135°

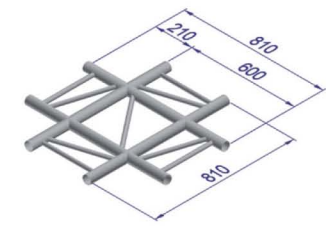

Type  
A4D ..... Angle 4 directions

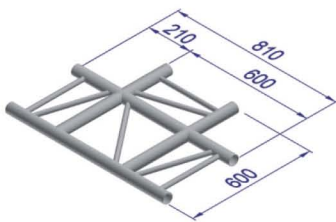

Type  
A3D ..... Angle 3 directions

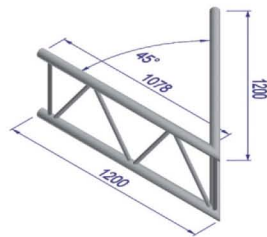

Type  
A2D45 ..... Angle 2 directions 45°

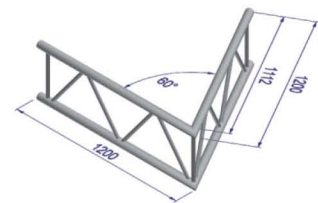

Type  
A2D60 ..... Angle 2 directions 60°

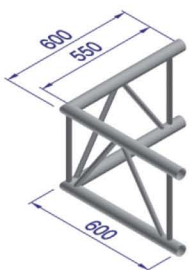

Type  
A2D90 ..... Angle 2 directions 90°

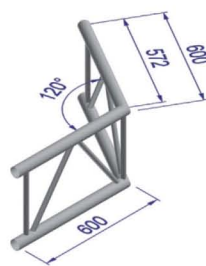

Type  
A2D120 ..... Angle 2 directions 120°

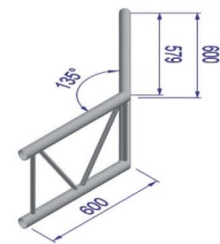

Type  
A2D135 ..... Angle 2 directions 135°

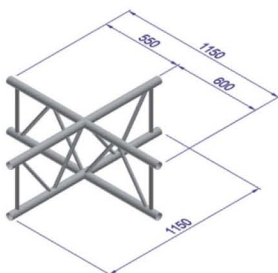

Type  
A4D ..... Angle 4 directions

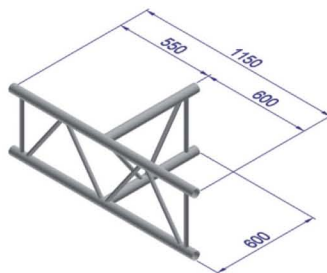

Type  
A3D ..... Angle 3 directions

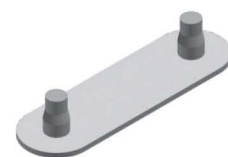

Type  
EMBP ..... Embase plate

STRUCTURES  
ALUMINIUM  
ALUMINIUM TRUSS

**POUTRES Série G40T / 41T**

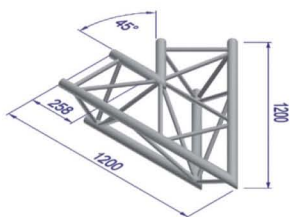

Type  
A2D45 ..... Angle 2 directions 45°

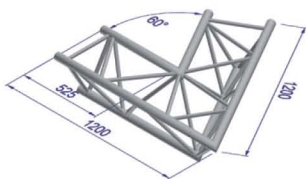

Type  
A2D60 ..... Angle 2 directions 60°

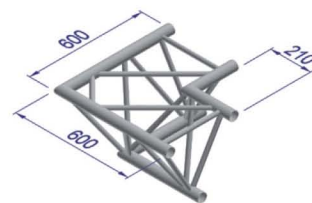

Type  
A2D90 ..... Angle 2 directions 90°

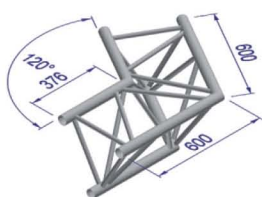

Type  
A2D120 ..... Angle 2 directions 120°

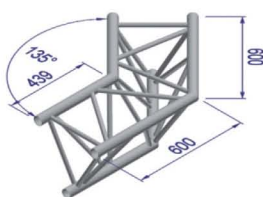

Type  
A2D135 ..... Angle 2 directions 135°

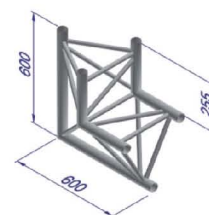

Type  
AD1PH ..... Angle portique pointe haute

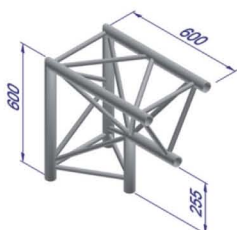

Type  
A1DPB ..... Angle portique pointe basse

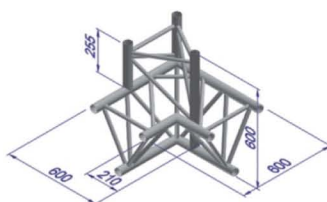

Type  
A2D90PH ..... Angle 2 directions 90°  
+ pied gauche

Pointe haute

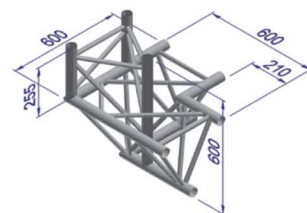

Type  
A2D90PH ..... Angle 2 directions 90°  
+ pied droit

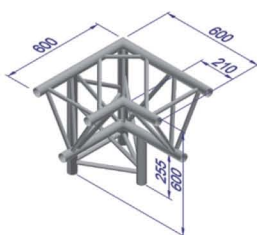

Type  
A2D90PB ..... Angle 2 directions 90°  
+ pied gauche

Pointe basse

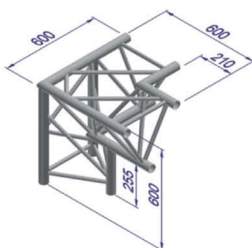

Type  
A2D90PB ..... Angle 2 directions 90°  
+ pied droit

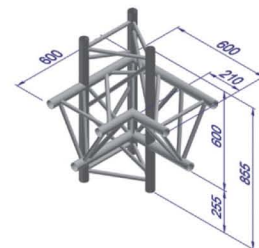

Type  
A2DP ..... Angle de « bar »

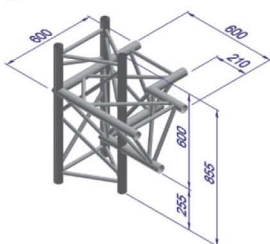

Type  
A2DP ..... Angle de « bar »

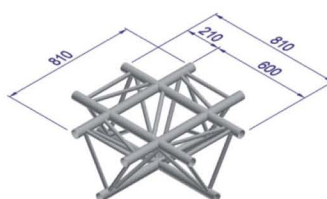

Type  
A4D ..... Angle 4 directions

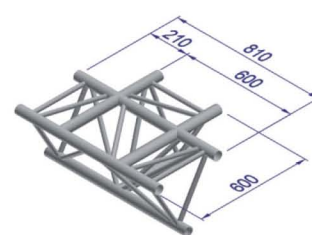

Type  
A3D ..... Angle 3 directions

**POUTRES** Série **G40T / 41T**

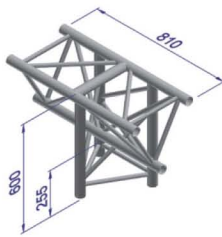

Type  
A2D180P .. Angle 2 directions 180° + pied

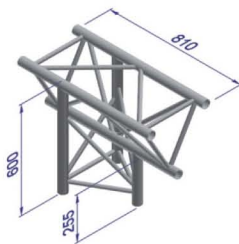

Type  
A2D180P .. Angle 2 directions 180° + pied

Pointe basse

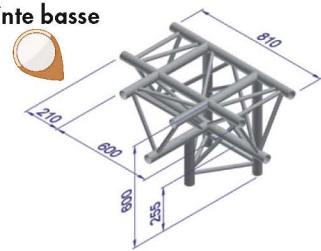

Type  
A3DP ..... Angle 3 directions + pied

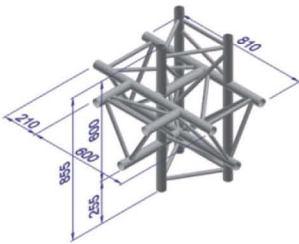

Type  
A3DPH Angle 3 directions + pied + haut

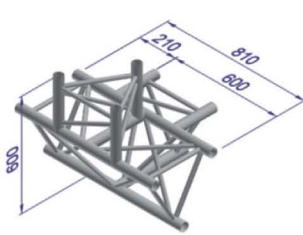

Type  
A3DP ..... Angle 3 directions + pied

Pointe basse

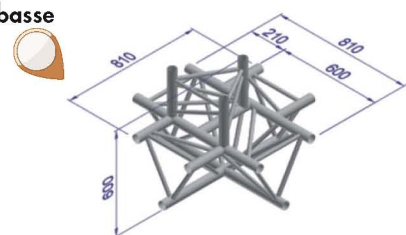

Type  
A4DP ..... Angle 4 directions + pied

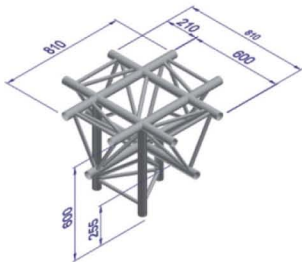

Type  
A4DP ..... Angle 4 directions + pied

Pointe basse

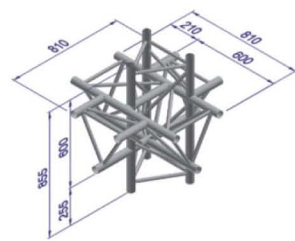

Type  
A4DPH Angle 4 directions + pied + haut



Type  
CHA ..... Angle charnière

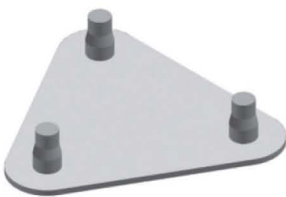

Type  
EMBP ..... Embase plate



**POUTRES** Série **G40C / 41C**

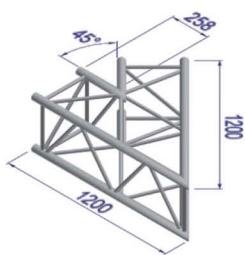

Type  
A2D45 ..... Angle 2 directions 45°

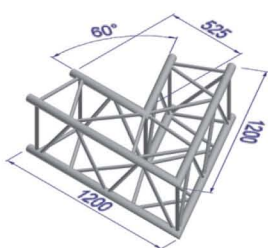

Type  
A2D60 ..... Angle 2 directions 60°

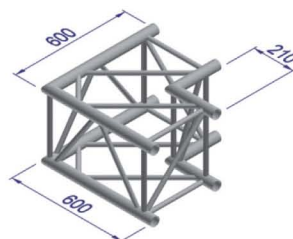

Type  
A2D90 ..... Angle 2 directions 90°

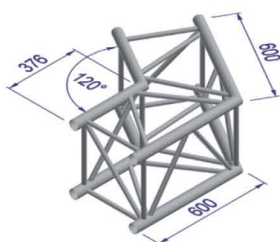

Type  
A2D120 ..... Angle 2 directions 120°

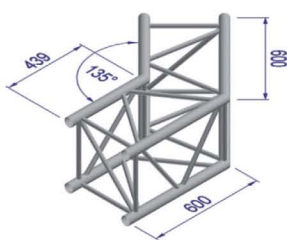

Type  
A2D135 ..... Angle 2 directions 135°

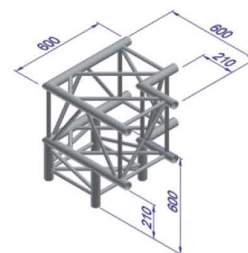

Type  
A2D90P Angle 2 directions 90° + pied

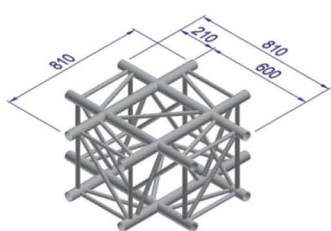

Type  
A4D ..... Angle 4 directions

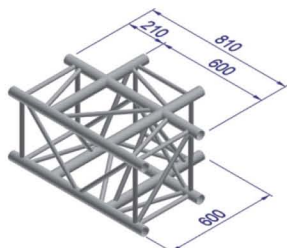

Type  
A3D ..... Angle 3 directions

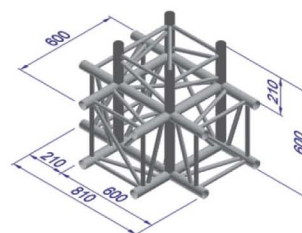

Type  
A3DP ..... Angle 3 directions + pied

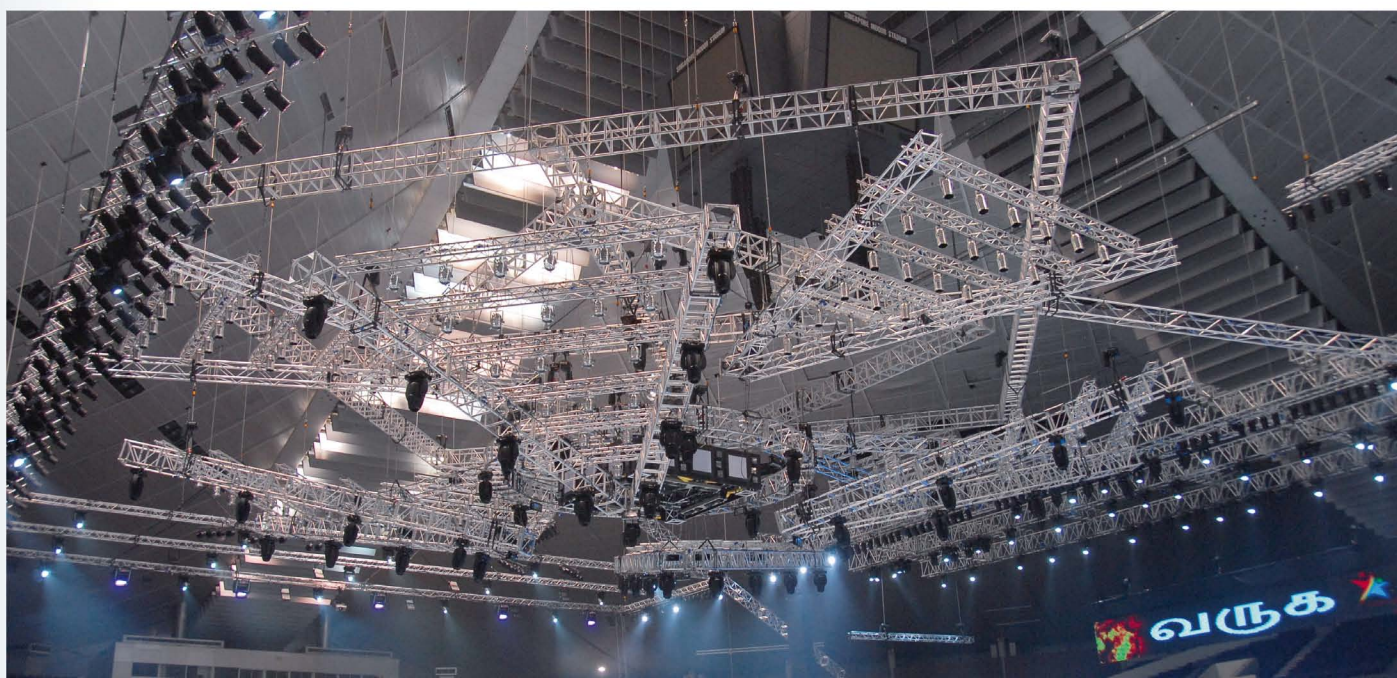

**POUTRES** Série **G40C / 41C**

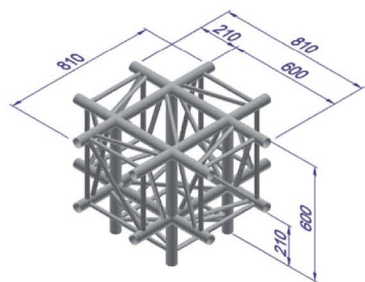

Type  
A4DP ..... Angle 4 directions + pied

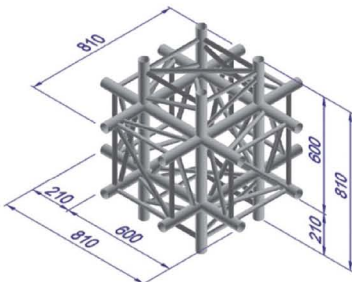

Type  
A4DPH Angle 4 directions + pied + haut

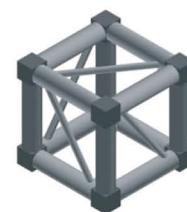

Type  
Boxcorner

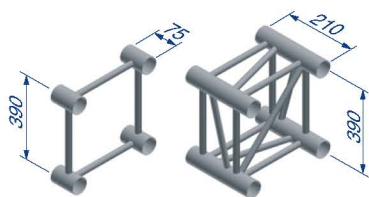

Type  
Raccord pour chariot de levage et  
boxcorner

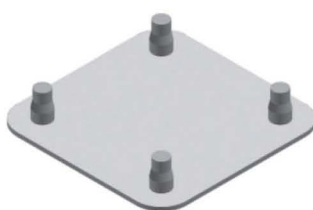

Type  
EMBP ..... Embase plate

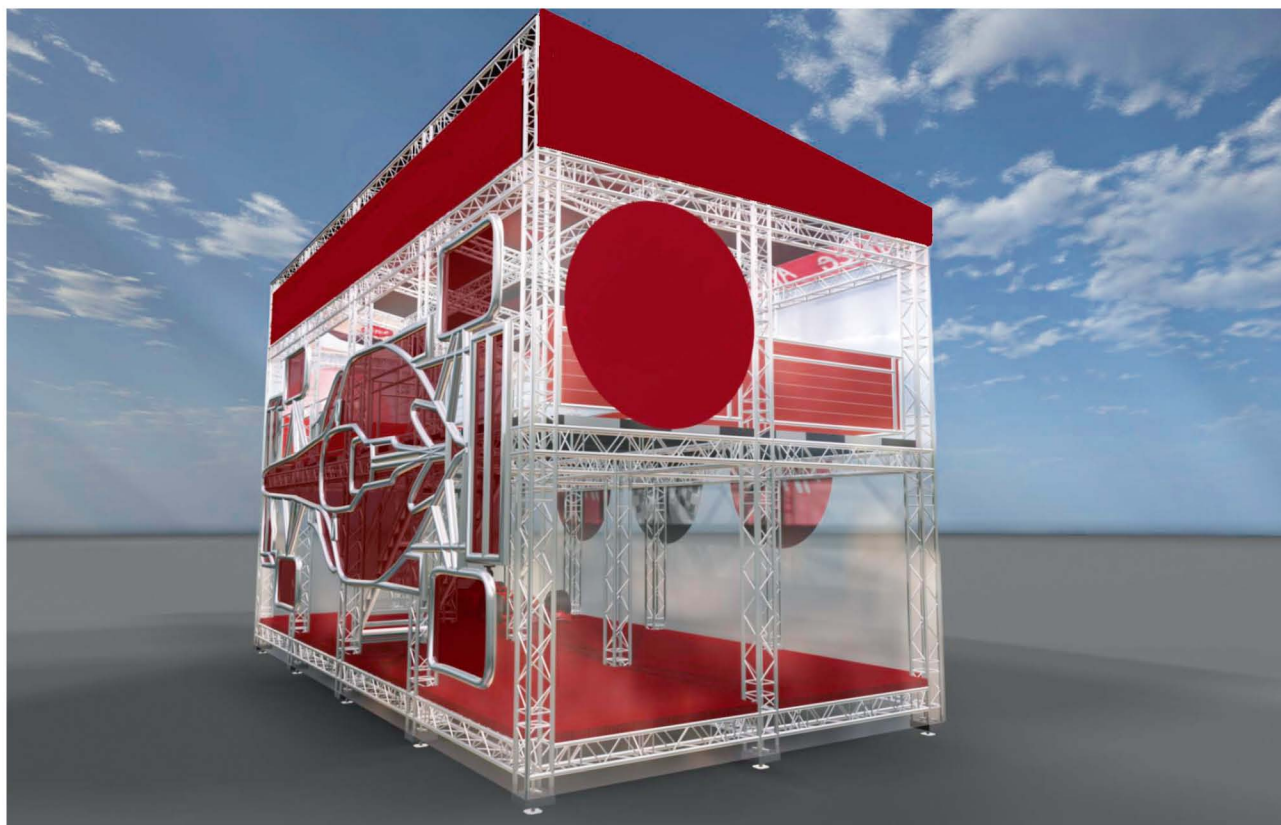

## POUTRES SÉRIE **G41** Échelle • Charges admissibles

<b>Poutre G41E - membrure principale ø 48 x 3 mm - croisillon ø 20 x 2 mm</b>			
<b>Longueur (M) / Span</b>	<b>3</b>	<b>4</b>	<b>5</b>
Charge ponctuelle (kg) / CPL	352	135	49
Charge 3 points (kg à 1/4, 1/2 et 3/4) / 3PL	146	60	25
Charge uniformément répartie (kg/M) / UDL/M	175	55	19
Charge uniformément répartie (kg) / UDL	528	220	96

## POUTRES SÉRIE **G40 / G41** Triangulaire • Charges admissibles

<b>Poutre G40T - membrure principale ø 50 x 2 mm - croisillon ø 20 x 2 mm</b>								
<b>Longueur (M) / Span</b>	<b>1</b>	<b>2</b>	<b>3</b>	<b>4</b>	<b>5</b>	<b>6</b>	<b>7</b>	<b>8</b>
Charge ponctuelle (kg) / CPL	427	289	249	234	264	211	186	173
Charge uniformément répartie (kg/M) / UDL/M	1327	644	480	319	203	149	104	80
Charge uniformément répartie (kg) / UDL	1327	1288	1440	1276	1015	894	728	640

<b>Poutre G41T - membrure principale ø 48 x 3 mm - croisillon ø 20 x 2 mm</b>					
<b>Longueur (M) / Span</b>	<b>4</b>	<b>5</b>	<b>6</b>	<b>7</b>	<b>8</b>
Charge ponctuelle (kg) / CPL	843	692	593	486	401
Charge 3 points (kg à 1/4, 1/2 et 3/4) / 3PL	386	328	280	236	199
Charge uniformément répartie (kg/M) / UDL/M	327	257	180	133	99
Charge uniformément répartie (kg) / UDL	1309	1286	1083	927	789

## POUTRES SÉRIE **G40 / G41** Carrée • Charges admissibles

<b>Poutre G40C - membrure principale ø 50 x 2 mm - croisillon ø 20 x 2 mm</b>					
<b>Longueur (M) / Span</b>	<b>1</b>	<b>2</b>	<b>3</b>	<b>4</b>	<b>5</b>
Charge ponctuelle (kg) / CPL	482	359	346	323	314
Charge uniformément répartie (kg/M) / UDL/M	1808	803	616	442	346
Charge uniformément répartie (kg) / UDL	1808	1605	1848	1768	1730

<b>Poutre G41C - membrure principale ø 48 x 3 mm - croisillon ø 20 x 2 mm</b>						
<b>Longueur (M) / Span</b>	<b>2</b>	<b>3</b>	<b>4</b>	<b>5</b>	<b>6</b>	<b>7</b>
Charge ponctuelle (kg) / CPL	1899	1891	1884	1671	1386	1181
Charge 3 points (kg à 1/4, 1/2 et 3/4) / 3PL	633	630	628	626	623	591
Charge uniformément répartie (kg/M) / UDL/M	949	630	471	375	312	266
Charge uniformément répartie (kg) / UDL	1899	1891	1884	1877	1870	1863



9	10	11	12
171	153	140	131
61	50	40	33
549	500	440	396



9	10	11	12	13	14	15	16
369	331	286	231	225	200	185	158
181	163	141	118	112	102	90	81
77	62	50	40	34	29	23	20
700	622	552	476	440	393	355	324



6	7	8	9	10	11	12
288	272	262	266	254	242	216
282	226	177	142	115	95	80
1692	1582	1416	1278	1150	1045	960



8	9	10	11	12	13	14	15	16	17	18	19	20
1027	906	808	728	661	603	553	509	470	436	405	376	350
513	453	404	364	330	301	276	255	235	218	202	188	175
232	201	162	132	110	93	79	68	59	51	45	40	35
1856	1812	1617	1456	1321	1206	1106	1018	941	871	809	753	701

# POUTRES SÉRIE G36

La série G36 a été spécialement conçue pour des utilisations à haute résistance pour les scènes, la construction de stands et les locations. En dépit de la forme compacte de la poutre G36, cette série peut être employée pour des constructions d'une portée maximale de 20 m avec un facteur de charge élevé. La poutre G36 est disponible en deux versions : rectangulaire et carrée. Grâce à sa forme effilée, le modèle rectangulaire est très demandé pour les utilisations dans lesquelles l'image visuelle produite joue un rôle important.

La poutre rectangulaire est en outre idéale d'un point de vue logistique (pour l'entreposage tout comme pour le transport).

*The G36 series has been specially designed for use in high strength scenes, stand construction and rentals. Despite the compact design of the truss, this series can be used for buildings with a maximum range of 20 m with a high load factor.*

*The truss G36 is available in two versions: rectangular and square. Thanks to its tapered shape, the rectangular design is highly demanded for utilisations in which visual image produced plays an important role.*

*The rectangular truss is also ideal for a logistics point of view (for storage as well as for transport).*

## Spécifications techniques

Type	R = rectangle C = carré	
Alliage	51 st. AlMgSi 1 F 31 ISO standard AlMgSi EN-AW 6082 T6	
Tube	ø 50 x 4 mm	
Croisillon	ø 25 x 3 mm	
Connection	Manchons, goupilles et broches	

Les raccords coniques (taille large) permettent un assemblage rapide et aisé, pratiquement sans outils. Europodium commercialise un large assortiment de cornières, d'arcs, de cercles et de montages spéciaux basés sur la série G36.

*Adapters (large size) allow quick and easy assembly, virtually without tools. Europodium sells a wide range of angles, arcs, circles and special assemblies based on the G36 series.*

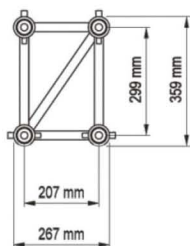

G36R

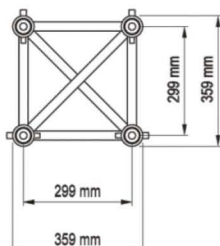

G36C

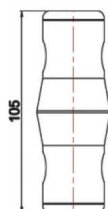

MC

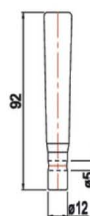

GC

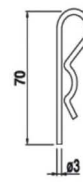

BS

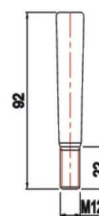

GCM12

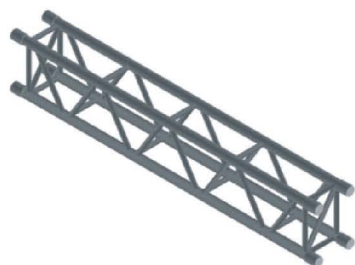

G36R

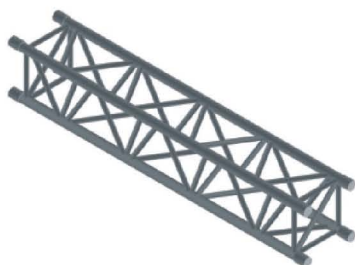

G36C



Pièces de connection

## Série G36 - tube ø 50 x 4 mm

Standard (m)	0,50	0,60	0,80	1,00	1,20	1,50	1,60	2,00	2,40	2,50	3,00	3,20	3,50	4,00
G36R (kg)	8,1	8,5	10,1	11,7	13,4	15,8	16,6	19,8	23,0	23,8	27,9	29,5	31,9	35,9
G36C (kg)	8,9	9,8	11,0	12,9	14,8	16,2	18,5	22,2	25,4	26,8	31,5	33,3	36,1	40,7

**POUTRES** Série **G36R**

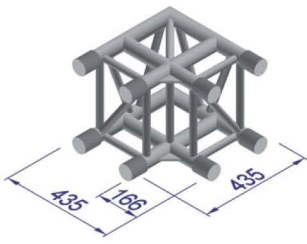

Type  
A2D90 ..... Angle 2 directions 90°

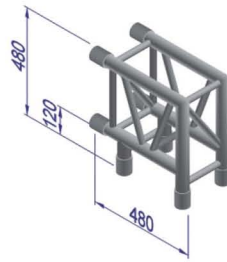

Type  
A1DP ..... Angle portique

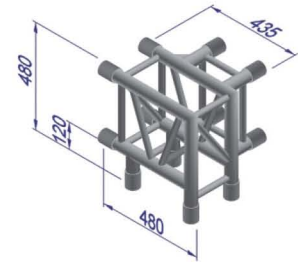

Type  
A2D90PG ..... Angle 2 directions +  
pied gauche

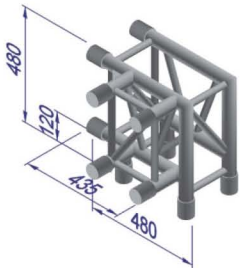

Type  
A2D90PD ..... Angle 2 directions  
+ pied droit

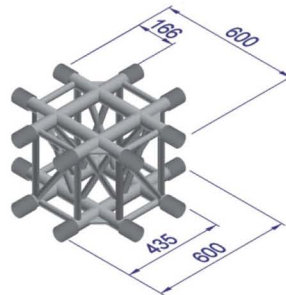

Type  
A4D ..... Angle 4 directions

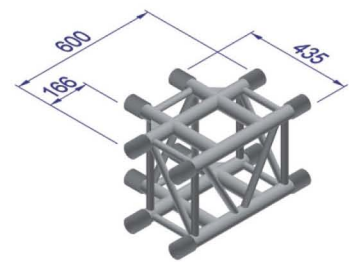

Type  
A3D ..... Angle 3 directions

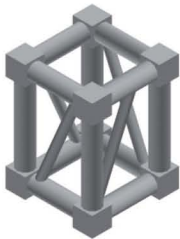

Type  
Boxcorner



Type  
Raccord de chariot de levage et  
boxcorner

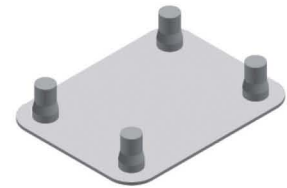

Type  
EMBP ..... Embase plate

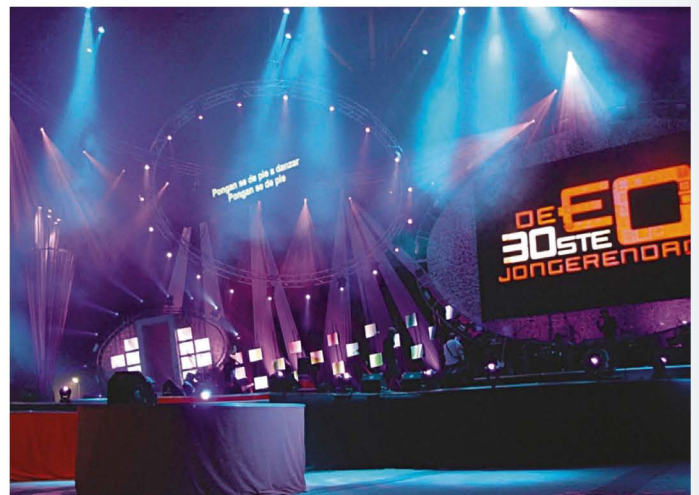

STRUCTURES  
ALUMINIUM  
ALUMINIUM TRUSS

**POUTRES Série G36C**

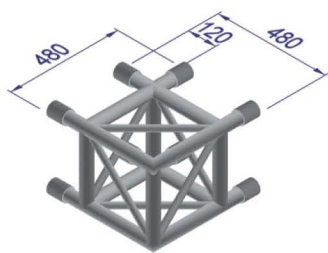

Type  
A2D90 ..... Angle 2 directions 90°

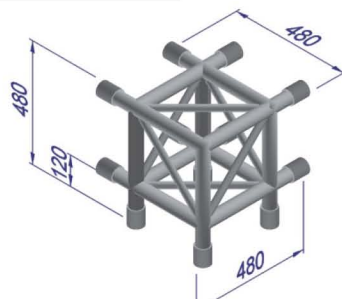

Type  
A2D90P ..... Angle 2 directions 90°  
+ pied

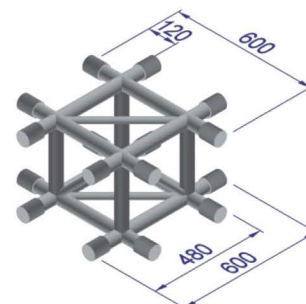

Type  
A4D ..... Angle 4 directions

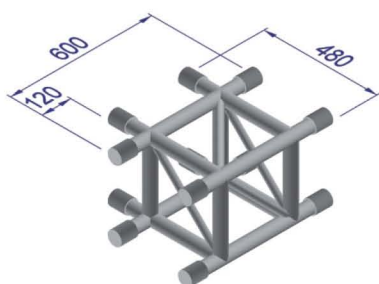

Type  
A3D ..... Angle 3 directions



Type  
Boxcorner



Type  
Raccord de chariot de levage et  
boxcorner

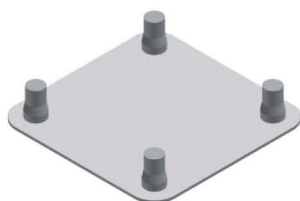

Type  
EMBP ..... Embase plate

**Charges admissibles Poutre G36R - membrure principale ø 50 x 4 mm - croisillon ø 25 x 3 mm**

Longueur (M) / Span	2	3	4	5	6	7	8
Charge ponctuelle (kg) / CPL	1737	1679	1719	1485	1469	1129	1257
Charge 3 points (kg à 1/4, 1/2 et 3/4) / 3PL	580	579	573	567	567	557	561
Charge uniformément répartie (kg/M) / UDL/M	870	576	430	343	283	242	210
Charge uniformément répartie (kg) / UDL	1739	1729	1721	1711	1701	1691	1683

**Charges admissibles Poutre G36C - membrure principale ø 50 x 4 mm - croisillon ø 25 x 3 mm**

Longueur (M) / Span	2	3	4	5	6	7	8
Charge ponctuelle (kg) / CPL	1767	1697	1732	1492	1474	1133	1238
Charge 3 points (kg à 1/4, 1/2 et 3/4) / 3PL	589	585	578	571	571	560	563
Charge uniformément répartie (kg/M) / UDL/M	884	583	434	346	285	244	211
Charge uniformément répartie (kg) / UDL	1769	1749	1738	1726	1714	1702	1690

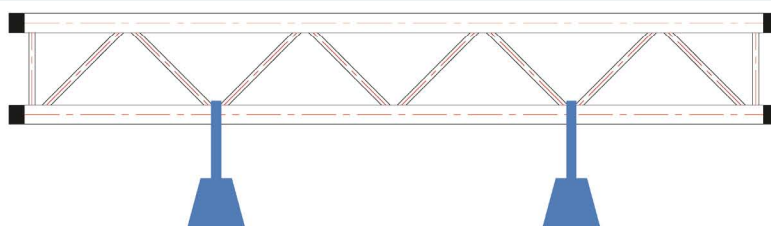

Les chiffres de charge donnés ne sont valables que pour l'utilisation d'une poutre triangulée en charge statique. Ceux-ci ont été déterminés conformément aux parties 1 et 2 de la norme DIN 4113. Lorsque les charges dynamiques sont prévues, les chiffres doivent être réduits de 50%. Pour d'autres conditions de charges, veuillez nous consulter.

Lors de l'emploi de tableaux des poids, le principe consiste à suspendre la charge à la poutre triangulée (au moyen d'un collier, d'une élingue, etc.) aussi près que possible de l'intersection des diagonales afin qu'elle soit répartie, dans la mesure du possible, entre (au moins) deux tubes principaux.

9	10	11	12	13	14	15	16	17	18	19	20
904	893	146	198	629	619	537	561	464	453	397	341
486	458	402	396	333	319	284	263	225	194	168	144
186	166	148	124	105	90	77	62	51	41	34	28
1673	1664	1622	1496	1360	1255	1158	999	858	740	637	547

9	10	11	12	13	14	15	16	17	18	19	20
905	892	744	782	626	614	531	544	456	443	381	325
486	458	401	388	330	316	280	258	219	188	161	138
187	167	147	147	104	89	76	61	49	40	33	27
1679	1668	1618	1491	1346	1234	1143	979	837	716	612	522

# POUTRES SÉRIE G50

La poutre G50 est disponible en deux modèles distincts. La poutre G50CV est dotée de croisillons sur les quatre côtés tandis que la poutre G50CL n'en comporte que sur deux côtés, les deux autres ayant des échelles.

La série G50 a été spécialement conçue pour des utilisations à très haute résistance, pour les scènes et les locations. Elle peut être employée pour des constructions d'une portée maximale de 24 m et des facteurs de charge très élevés.

*The truss G50 is available in two different models. The beam is provided with braces G50CV on four sides, while the beam comprises G50CL not only on two sides, the other two with ladders.*

*The G50 series has been specially designed for use at very high resistance to the scenes and locations. It can be used for buildings with a maximum range of 24 m and very high load factors.*

## Spécifications techniques

Type	CL = carré CV = carré
Alliage	51 st. AlMgSi 1 F 31 ISO standard AlMgSi EN-AW 6082 T6
Tube	ø 50 x 4 mm
Croisillon	ø 30 x 3 mm
Connexion	Manchons, goupilles et broches



Les raccords coniques (taille large) permettent un assemblage rapide et aisé, pratiquement sans outils.

*Adapters (large size) allow quick and easy assembly, virtually without tools.*

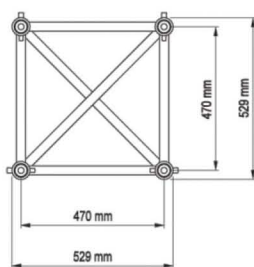

G50CV

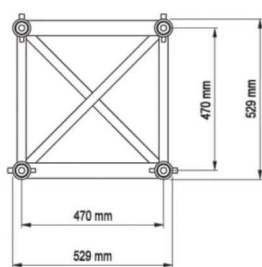

G50CL

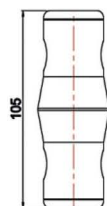

MC

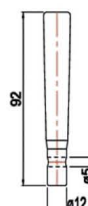

GC

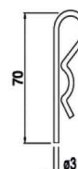

BS

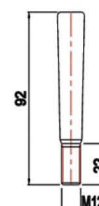

GCM12

## Charges admissibles Poutre G50CV - membrure principale ø 50 x 2 mm - croisillon ø 16 x 2 mm

Longueur (M) / Span	2	3	4	5	6	7	8	9	10
Charge ponctuelle (kg) / CPL	4291	4279	4266	3448	2862	2442	2125	1878	1678
Charge 3 points (kg à 1/4, 1/2 et 3/4) / 3PL	1431	1426	1423	1419	1414	1221	1063	939	839
Charge uniformément répartie (kg/M) / UDL/M	2146	1427	1067	851	708	605	528	418	336
Charge uniformément répartie (kg) / UDL	4292	4281	4268	4255	4248	4235	4224	3762	3360

## Charges admissibles Poutre G50CL - membrure principale ø 50 x 4 mm - croisillon ø 50 x 4 mm et

Longueur (M) / Span	2	3	4	5	6	7	8	9	10
Charge ponctuelle (kg) / CPL	4291	4279	4266	3448	2862	2442	2125	1878	1678
Charge 3 points (kg à 1/4, 1/2 et 3/4) / 3PL	1431	1426	1423	1419	1414	1221	1063	939	839
Charge uniformément répartie (kg/M) / UDL/M	2146	1427	1067	851	708	605	528	418	336
Charge uniformément répartie (kg) / UDL	4292	4281	4268	4255	4248	4235	4224	3762	3360



G50CV



G50CL



Pièces de connection

Série G50 - tube  $\varnothing$  50 x 4 mm

Standard (m)	0,50	0,60	0,80	1,00	1,20	1,50	1,60	2,00	2,40	2,50	3,00	3,20	3,50	4,00
G50CV (kg)	9,4	10,5	12,8	15,1	17,4	20,8	21,9	26,5	31,1	32,2	37,9	40,2	43,6	49,3
G50CL (kg)	9,6	10,8	13,1	15,5	17,9	21,4	22,6	27,4	32,1	33,3	39,2	41,6	45,1	51,0

POUTRES Série G50CV / G50CL

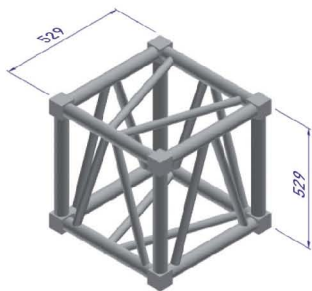

Type  
Boxcorner



Type  
Raccord de chariot de levage et  
boxcorner

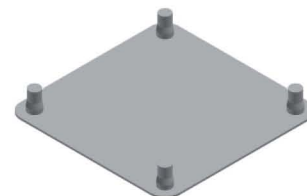

Type  
EMBP ..... Embase plate

	12	14	16	18	20	22	24	26	28	30
	1376	1157	990	857	748	657	579	511	451	397
	688	579	495	429	374	329	290	256	226	199
	230	166	124	96	75	600	49	40	33	27
	2760	2324	1984	1728	1500	1320	1176	1040	924	810



$\varnothing$  30 x 3 mm

	12	14	16	18	20	22	24	26	28	30
	1376	1157	990	857	748	657	579	511	451	397
	688	579	495	429	374	329	290	256	226	199
	230	166	124	96	75	600	49	40	33	27
	2760	2324	1984	1728	1500	1320	1176	1040	924	810



# POUTRES SÉRIE G60R

La série G60R a été spécialement conçue pour des utilisations à très haute résistance, pour les scènes et les locations. Elle peut être employée pour des constructions d'une portée maximale de 24 m et des facteurs de charge très élevés.

*The G60R series has been specially designed for use at very high resistance to the scenes and locations. It can be used for buildings with a maximum range of 24 m and very high load factors.*

## Spécifications techniques

Type	G60R
Alliage	51 st. AlMgSi 1 F 31 ISO standard AlMgSi EN-AW 6082 T6
Tube	ø 50 x 4 mm
Croisillon	ø 30 x 3 mm ø 50 x 4 mm
Connection	Manchons, goupilles et broches

Les raccords coniques (taille large) permettent un assemblage rapide et aisé, pratiquement sans outils. Europodium commercialise un large assortiment de cornières, d'arcs, de cercles et de montages spéciaux basés sur la série G60R.

*Adapters (large size) allow quick and easy assembly, virtually without tools. Europodium sells a wide range of angles, arcs, circles and special assemblies based on the G60R series.*

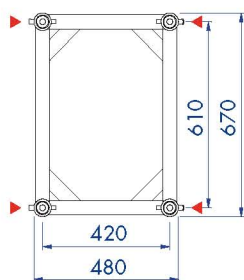

G60

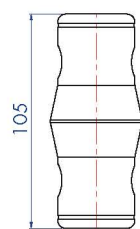

MC

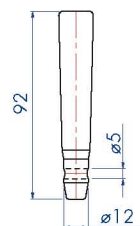

GC

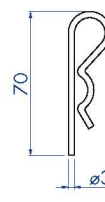

BS

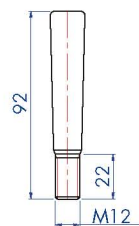

GCM12

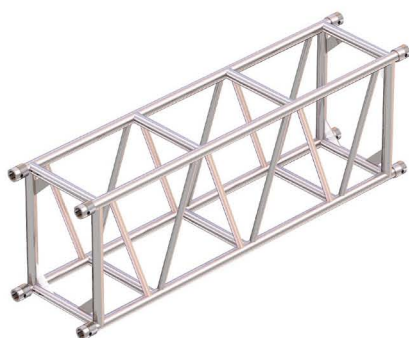

G60R



Pièces de connection

## Poutre G60R - tube ø 50 x 4 mm

Standard (m)	<b>0,50</b>	<b>1,00</b>	<b>1,50</b>	<b>2,00</b>	<b>3,00</b>
G60R (kg)	10	17	26	34	51

## Charges admissibles Poutre G60R - membrure principale ø 50 x 4 mm - croisillon ø 30 x 3 mm

Longueur (M) / Span	2	3	4	5	6	7	8	9	10
Charge ponctuelle (kg) / CPL	5689	5672	5044	4019	3334	2842	2471	2180	1946
Charge 3 points (kg à 1/4, 1/2 et 3/4) / 3PL	1896	1891	1885	1879	1667	1421	1235	1090	973
Charge uniformément répartie (kg/M) / UDL/M	2845	1891	1414	1128	937	801	618	484	389
Charge uniformément répartie (kg) / UDL	5690	5673	5656	5640	5622	5607	4944	4356	3890

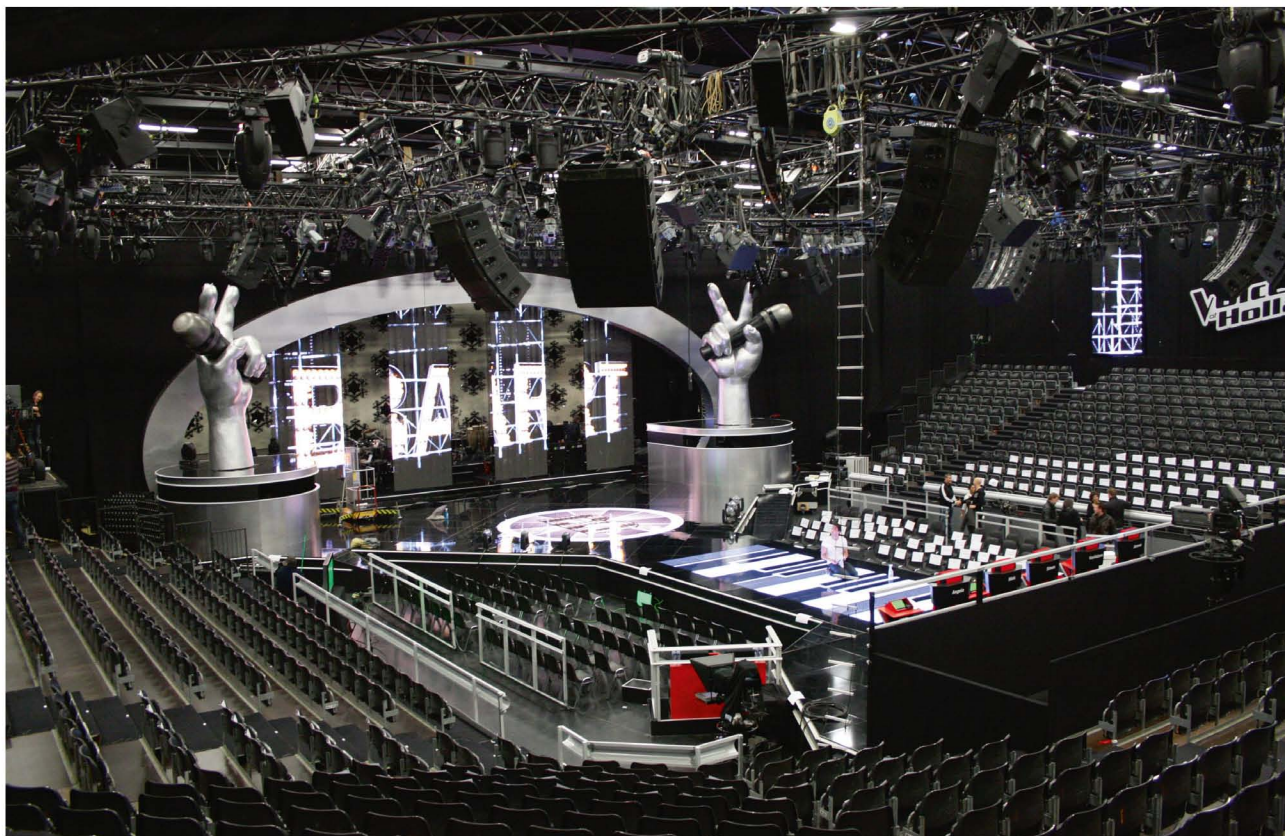
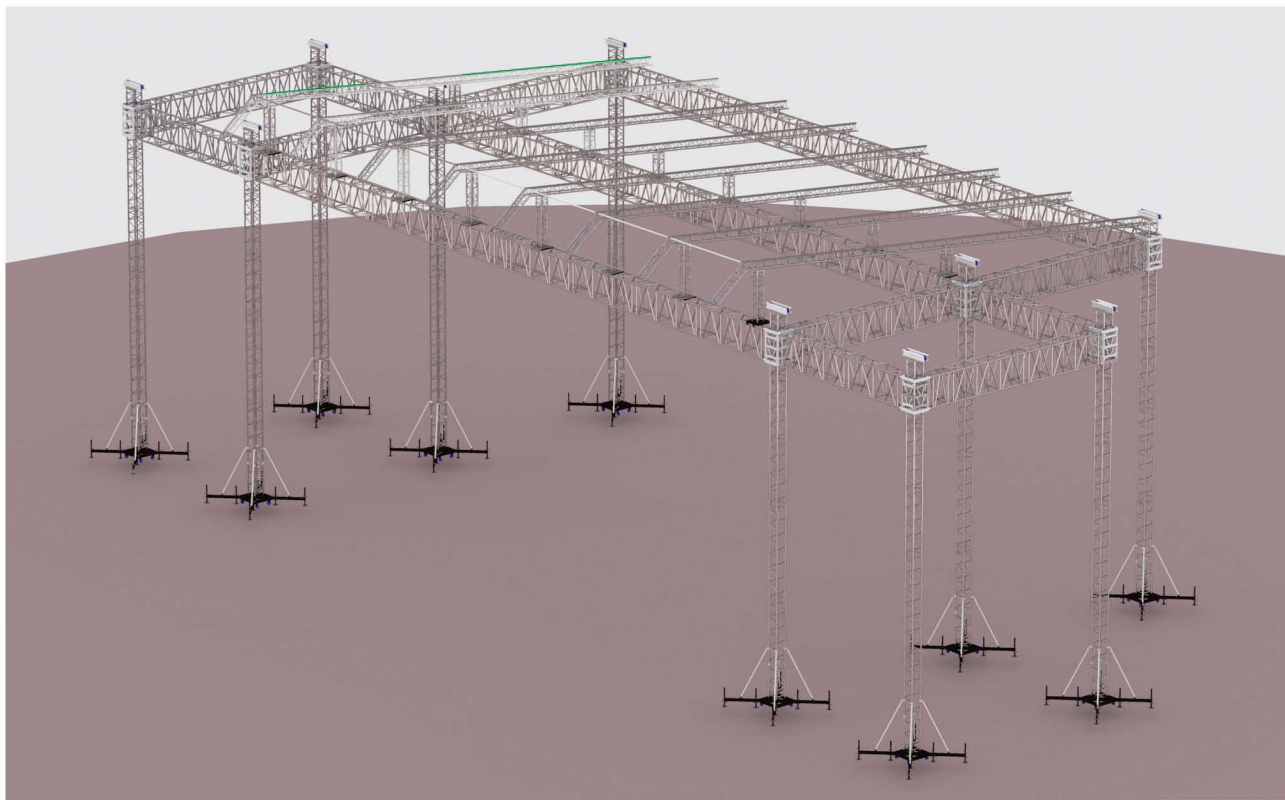

STRUCTURES  
ALUMINIUM  
ALUMINIUM TRUSS

11	12	13	14	15	16	17	18	19	20	21	22	23	24
1753	1590	1452	1331	1226	1133	1050	975	907	845	788	736	687	642
876	795	726	666	613	567	525	488	454	423	391	368	344	321
319	265	223	190	164	142	124	108	96	85	75	67	60	54
3509	3180	2899	2660	2460	2272	2108	1944	1824	1700	1575	1474	1380	1296

# POUTRES SÉRIE G100

Notre gamme de structures aluminium à très forte capacité de charge vient de s'enrichir de sa poutre la plus résistante avec le lancement de la poutre G100.

La poutre G100 est dotée d'une membrure principale de 60 x 6 mm et de diagonales de 48 x 3 et 30 x 3 mm en aluminium de qualité EN-AW 6082 T6, ce qui permet une grande capacité de charge et ce jusqu'à 40 m d'ouverture.

La poutre aluminium G100 permet d'accroître les possibilités d'utilisation et devient indispensable pour les projets à grande échelle. L'assemblage de celle-ci s'effectue par manchon conique (identique à ceux des séries G50 et G60) avec une connexion à l'intérieur des membrures principales de 160 mm permettant de travailler rapidement en toute sécurité.

*Our Jumbo series has acquired a fully-fledged Pre Rigg truss with the launch of the G100 truss. A main pipe of 60 x 6 mm and diagonals of 48 x 3 and 30 x 3 mm (EN-AW 6082 T6) have resulted in spans with a high load capacity now also forming part of the possibilities. The coupling itself will enter the main pipe by some 160 mm; this has finished off this truss' mechanical construction. The G100 works with the same conical connection pieces as the G50 and G60. The conical connection pieces result in a fast and safe connection.*

## Spécifications techniques

Type	G100
Alliage	51 st. AlMgSi 1 F 31 ISO standard AlMgSi EN-AW 6082 T6
Tube	ø 60 x 6 mm
Croisillon	ø 48 x 3 mm ø 30 x 3 mm
Connection	Manchons, goupilles et broches

Les raccords coniques (taille large) permettent un assemblage rapide et aisé, pratiquement sans outils. Europodium commercialise un large assortiment de cornières, d'arcs, de cercles et de montages spéciaux basés sur la série G50.

*Adapters (large size) allow quick and easy assembly, virtually without tools. Europodium sells a wide range of angles, arcs, circles and special assemblies based on the G50 series.*

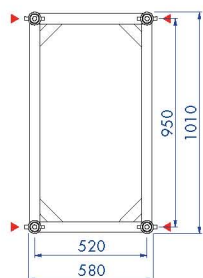

G100

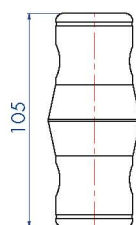

MC

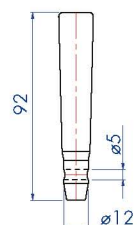

GC

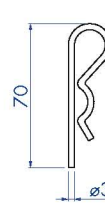

BS

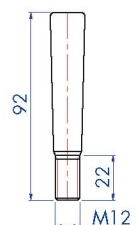

GCM12

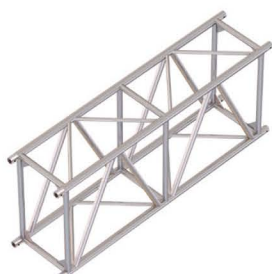

G100

## Poutre G100 - tube ø 60 x 6 mm

Standard (m)	1,00	1,20	2,00	2,40	3,00
G100 (kg)	27	33	47	58	72

## Charges admissibles Poutre G100 - membrure principale ø 60 x 6 mm - croisillon ø 48 x 3 mm et

Longueur (M) / Span	8	9	10	11	12	13	14	15	16	17	18	19	20
Charge ponctuelle (kg) / CPL	5631	4981	4400	4030	3671	3364	3099	2869	2665	2485	2322	2176	2043
Charge 3 points (kg à 1/4, 1/2 et 3/4) / 3PL	2815	2492	2230	2015	1840	1682	1550	1435	1333	1243	1161	1088	1022
Charge uniformément répartie (kg/M) / UDL/M	1408	1107	892	733	612	518	443	383	333	293	258	229	205
Charge uniformément répartie (kg) / UDL	11264	9963	8920	8063	7344	6734	6202	5745	5328	4981	4644	4351	4100

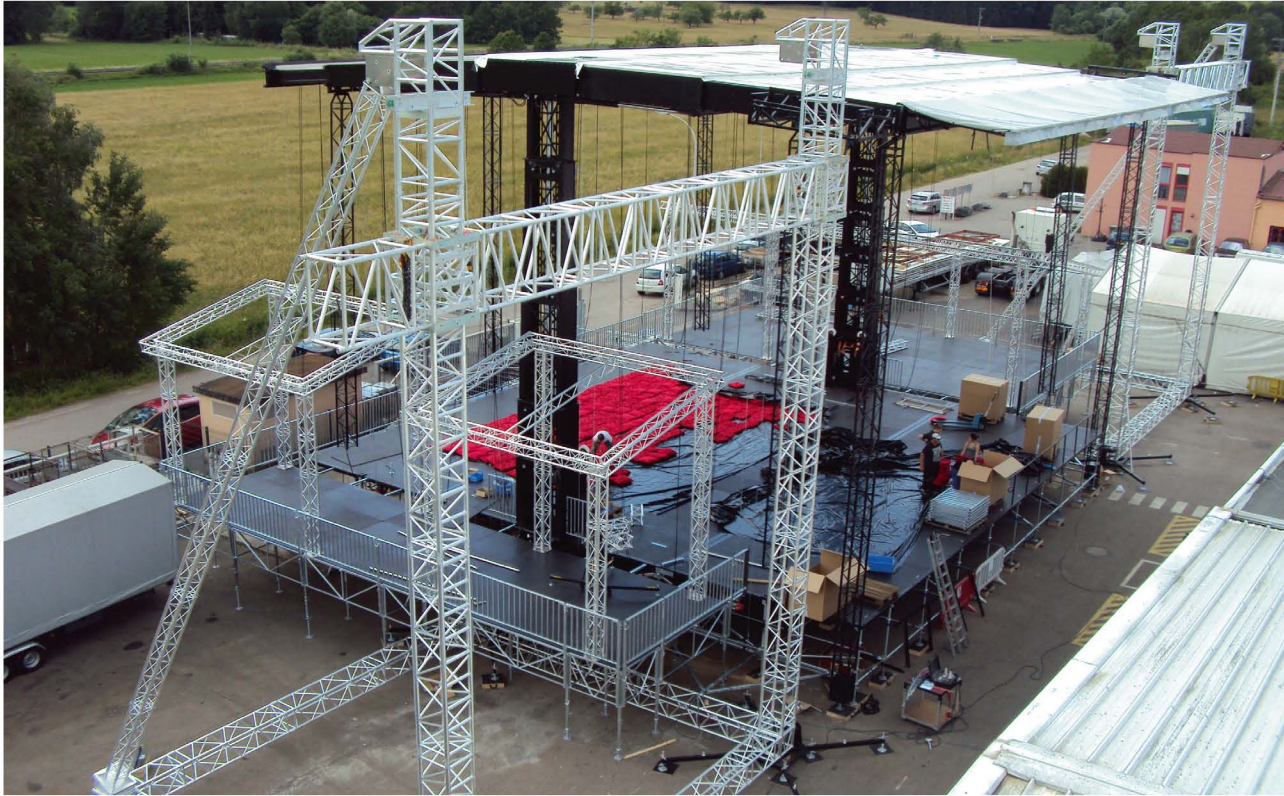

**30 x 3 mm**

21	22	23	24	25	26	27	28	29	30	31	32	33	34	35	36	37	38	39	40
1920	1809	1706	1610	1521	1438	1360	1287	1218	1153	1091	1033	977	923	872	823	777	731	688	646
960	904	853	805	761	720	680	644	609	577	546	516	488	462	436	412	388	366	344	323
183	164	148	134	122	111	101	92	84	77	70	65	59	54	50	46	42	39	35	32
3843	3617	3404	3216	3050	2886	2727	2576	2436	2310	2170	2080	1947	1836	1750	1656	1554	1482	1365	1280

# POUTRES SÉRIE GAT500N

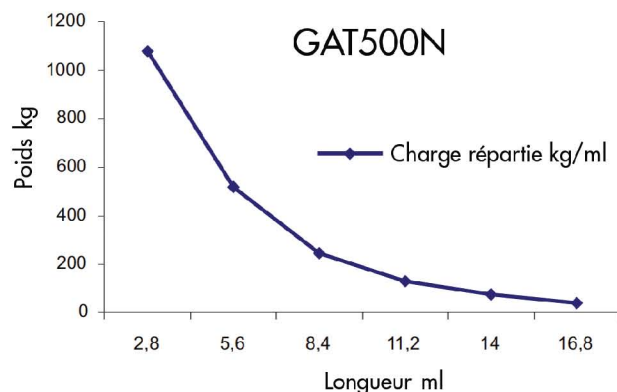
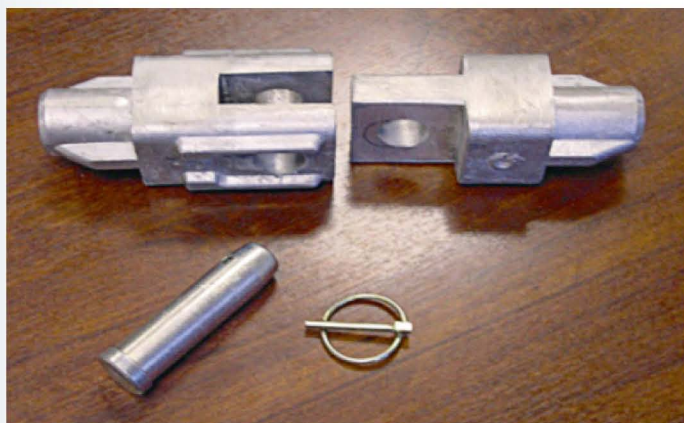

## Spécifications techniques

Type	Triangulaire
Alliage	ISO standard AlMgSi EN-AW 6060 T5
Tube	ø 50 x 2 mm
Croisillon	ø 30 x 3 mm
Connexion	Goupilles et clips de sécurité

Europodium commercialise une large gamme de produits particuliers basés sur la série GAT500N.

*Europodium markets a wide range of specific products based on the series GAT500N.*

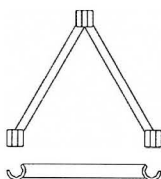
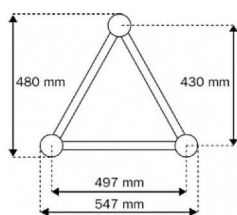

GAT500N



GAT / GA



GAT / CS

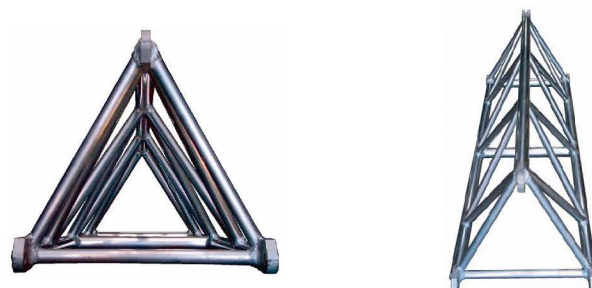
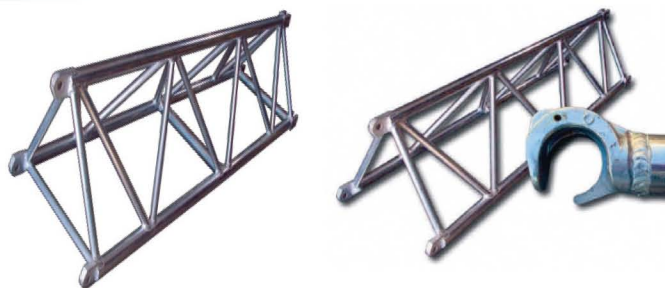

GAT500N



**POUTRES** Série **GAT500N**

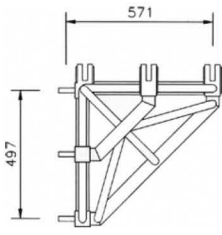

Type  
A2D ..... Angle 2 directions 90°

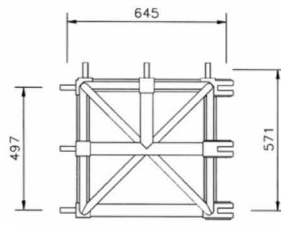

Type  
A3D ..... Angle 3 directions

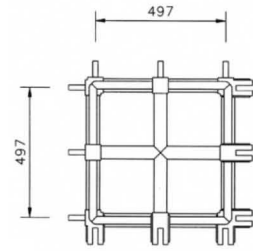

Type  
A4D ..... Angle 4 directions

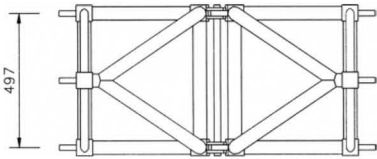

Type  
CAR ..... Cardan

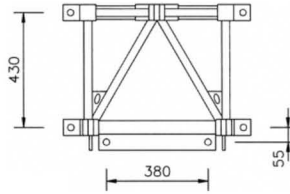

Type  
A4D ..... Angle acier 4 directions

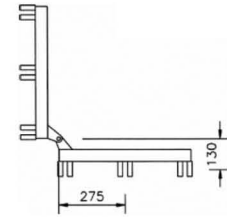

Type  
CHA ..... Charnière

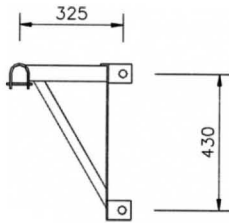

Type  
A1D M/F ..... Angle linéaire M/F

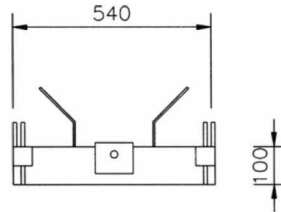

Type  
DPA ..... Raccord bac à chaîne

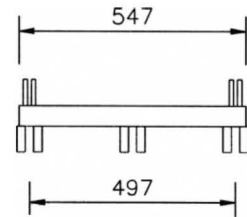

Type  
APA ..... Raccord départ pied

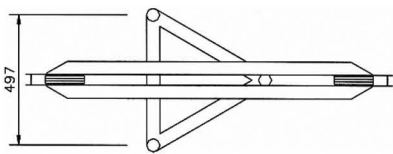

Type  
TDT ..... Tête de tour

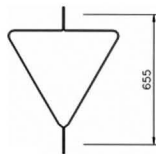

Type  
TD ..... Triangle de suspension

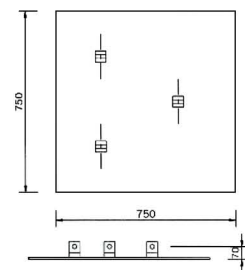

Type  
EMBP ..... Embase plate

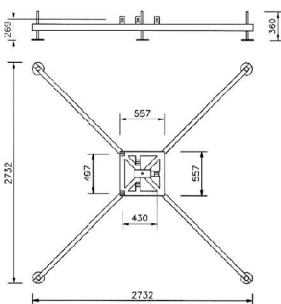

Type  
EMB ..... Embase

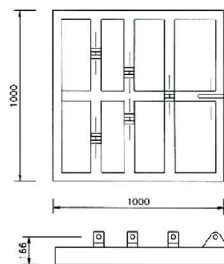

Type  
PT ..... Platine tubulaire

# TRIPOD



Système de tour de son monté en 30 minutes sans chariot élévateur.

*Tower system mounted in 30 minutes without forklift.*

## Spécifications techniques

Hauteur 9 m - 10,5 m - 12 m

Capacité de charge 2,5 T

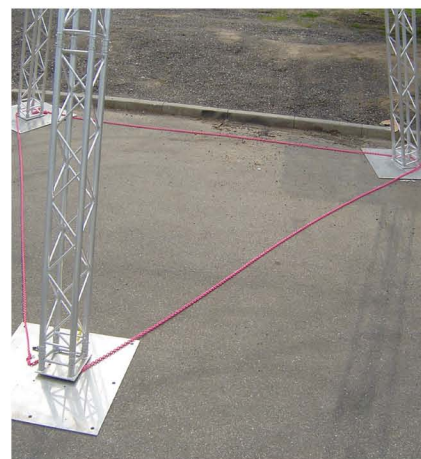
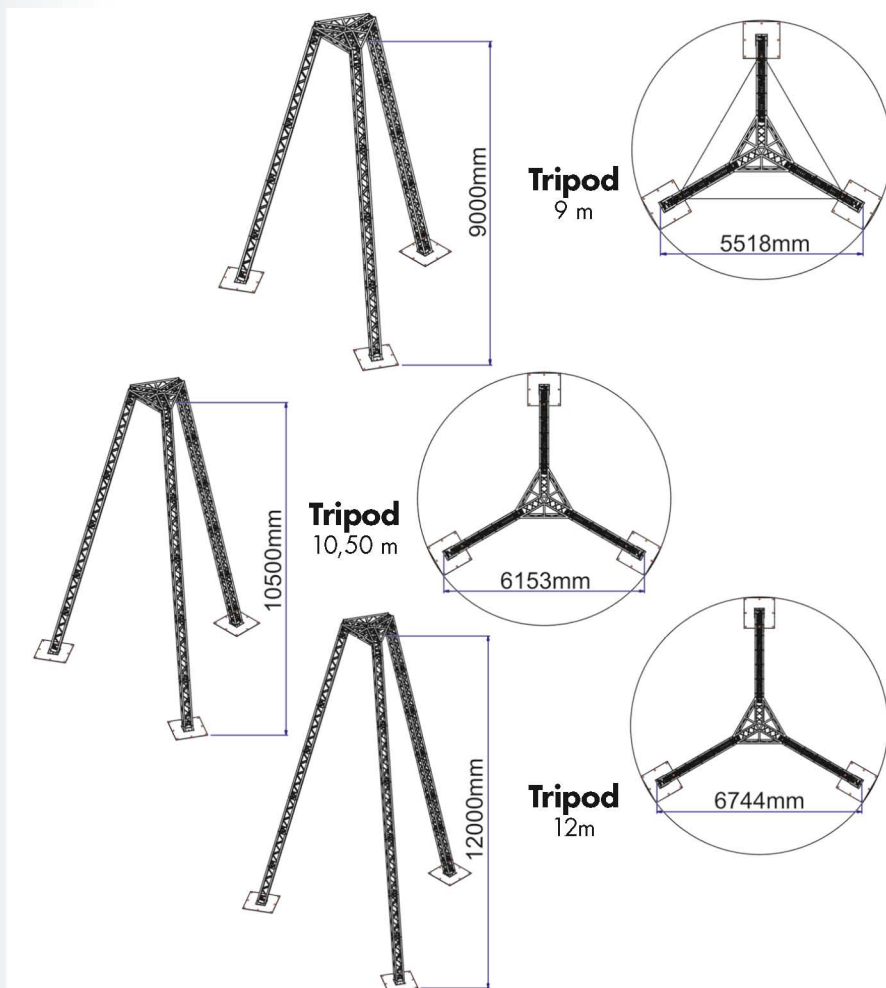

# ACCESSOIRES STRUCTURES ALU



Demi-manchon rallongé /  
Extended half-coupler



Manchon rallongé /  
Extended conical coupler



Manchon charnière /  
Hing coupler



Demi-manchon /  
Half-coupler



Griffe IPN / IPN clamp



Crochet pour projecteur 250 kg /  
Projector clamp 250 kg



Profilé double gorge /  
Double slit profile



Profilé simple gorge /  
Simple slit profile



Triangle de suspension /  
Triangle suspension frame



Carré de suspension /  
Square suspension frame



Collier double orientable 100 kg /  
Orientable double clamp 100 kg



Collier double orientable 500 kg /  
Orientable double clamp 500 kg



Collier simple 500 kg /  
Clamp 500 kg



Collier simple 100 kg /  
Clamp 100 kg



Collier simple 200 kg /  
Clamp 200 kg



Collier à œillets 200 kg /  
Eyelet clamp 200 kg



Main de singe /  
Claw

STRUCTURES  
ALUMINIUM  
ALUMINIUM TRUSS